



BORING SYSTEM

NO.B.75-1903A



www.syic.com

INDEX

DAMPING BORING SERIES

PSC / SPMB DAMPING FINISH BORING HEAD	P.4
SRBH-LA DAMPING TWIN-BIT ROUGH BORING HEAD	P.6
SCBH DAMPING FINISH BORING HEAD	P.7
SLBK DAMPING EXTENSION SPACER	P.8
DAMPING BORING HEAD SHANK / HOLDER	P.9

ROUGH & FINISH BORING HEAD

ROUGHING TWIN ADJUSTMENT BORING HEAD	P.12
SMU BLACK KNIGHT FINISH BORING HEAD	P.13
SUPER MICRON EXCHANGEABLE FINISH BORING HEAD	P.14
SBJ BORING HEAD FOR FINISHING	P.15
SLEEVE FOR TUNGSTEN STEEL TOOL HOLDER	P.15
SBE EXTENDED BORING INSERT SEAT	P.16
ANTI-VIBRANT TUNGSTEN STEEL TOOL HOLDER	P.17
THROW - AWAY BORING HEAD	P.18
SBJ BORING CUTTER	P.19
BYB BORING HEAD	P.20
BYB FINISH BORING HEAD BODY	P.20
RBH-LA INDEXABLE TWIN-BIT ROUGH BORING HEAD	P.21
CBH FINISH BORING HEAD	P.22
MBH FINISH BORING HEAD	P.23
CBI SMALL DIAMETER FINISH BORING HEAD	P.24
SRW ROUGHING BORING HEAD	P.25
SMB SUPER MICRON EXCHANGEABLE FINISH BORING HEAD	P.26
PSC / PMB FINISH BORING HEAD	P.27
PSC / PCK ROUGH BORING HEAD	P.28
PSC / PBJ FINISH BORING HEAD	P.28

MCK BORING HEAD SHANK / HOLDER

BT / MCK BORING HEAD SHANK	P.32~36
CAT / MCK BORING HEAD SHANK	P.37
DAT / MCK BORING HEAD SHANK	P.38
SBT / MCK BORING HEAD SHANK	P.39~42
SCAT / MCK BORING HEAD SHANK	P.43
SDAT / MCK BORING HEAD SHANK	P.44
HSK / MCK BORING HEAD SHANK	P.45~46
PSC / MCK BORING HEAD SHANK	P.47~48

MCK ACCESSORIES

MCK EXTENSION SPACER	P.51
SIMPLIFIED TOOL PRESETTER FOR SRW & SMB BORING HEAD	P.52

PSC ADAPTERS

BT / PSC ADAPTERS	P.56
CAT / PSC ADAPTERS	P.57
DAT / PSC ADAPTERS	P.58
SBT / PSC ADAPTERS	P.59
SCAT / PSC ADAPTERS	P.60
SDAT / PSC ADAPTERS	P.61
HSK / PSC ADAPTERS	P.62
PSC / EXTENSION ADAPTER FOR SAME DIAMETER	P.63
PSC / EXTENSION ADAPTER FOR DIFFERENT DIAMETER	P.64

DAMPING BORING SERIES

PSC / SPMB DAMPING FINISH BORING HEAD	P.4
SRBH-LA DAMPING TWIN-BIT ROUGH BORING HEAD	P.6
SCBH DAMPING FINISH BORING HEAD	P.7
SLBK DAMPING EXTENSION SPACER	P.8
DAMPING BORING HEAD SHANK / HOLDER	P.9



BUILT-IN DAMPING MECHANISM

SILENT DAMPING GENIUS

FOR BORING SERIES

SDG **KPZ**
SILENT DAMPING GENIUS

NEW



Silent Damping Genius is an anti-vibration technology for long overhanging and deep cavity operations.

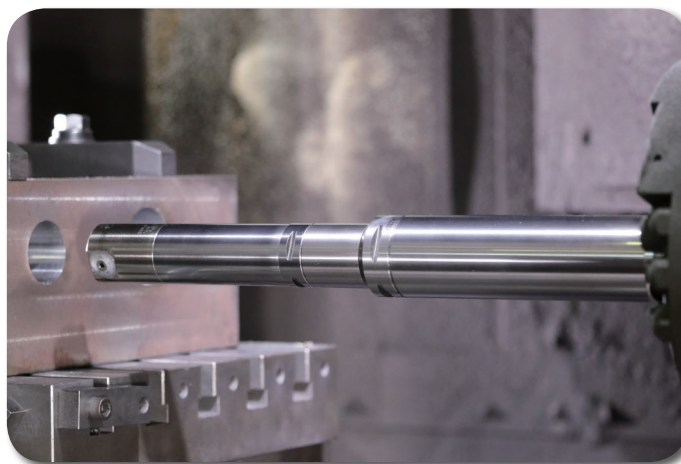
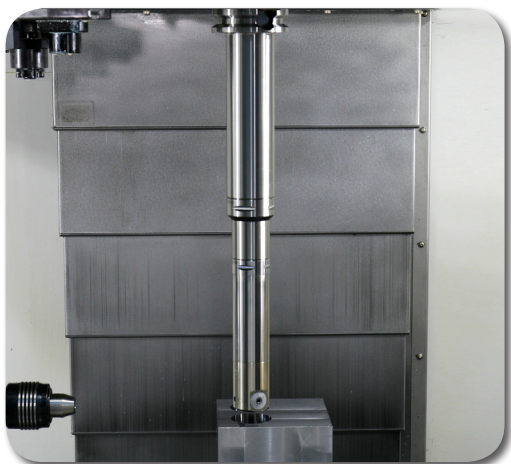

- ▶ Silent Damping Genius equipped with damping mechanism eliminates vibration, improves workpiece surface finish, roundness, tool life, maintain spindle precision, and increase the overall production efficiency!

Set 
upright
in stock



REMINDER

- ▶ The closer vibrating point gets to the damping mechanism, the higher damping effect will be.
- ▶ To maintain runout accuracy, all damping products need to be placed upright in stock.

PSC / SPMB DAMPING FINISH BORING HEAD

PSC / SPMB 抑震精密微調搪頭



One-piece

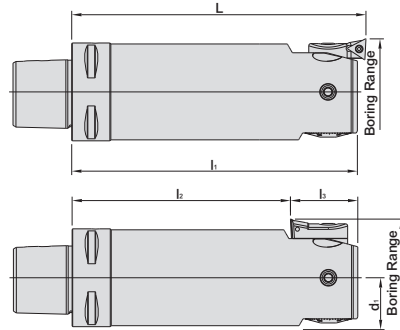

MODEL NO.	TYPE	BORING AND PROCESSING AT FRONT			BORING AND PROCESSING AT BACK			
		BORING RANGE	L	l ₁	BORING RANGE	l ₂	l ₃	d ₁
140.657.32V.115	PSC32 x SPMB32 - 115	32 ~ 42	115	110	-	90	25	16
		41 ~ 51	115	110	46 ~ 51	90	25	16
		50 ~ 60	115	110	50 ~ 60	90	25	16
141.657.41V.125	PSC40 x SPMB41 - 125	41 ~ 54	125	121	-	96	29	20
		50 ~ 63	125	121	53 ~ 63	96	29	20
		61 ~ 74	125	121	61 ~ 74	96	29	20
142.657.53V.150	PSC50 x SPMB53 - 150	53 ~ 70	150	146	62 ~ 70	116	34	25.5
		65 ~ 82	150	146	65 ~ 82	116	34	25.5
		78 ~ 95	150	146	78 ~ 95	116	34	25.5
143.657.68V.190	PSC63 x SPMB68 - 190	68 ~ 100	190	186.2	80 ~ 100	114.8	45.2	32.5
		94 ~ 126	190	186.2	94 ~ 126	114.8	45.2	32.5
		118 ~ 150	190	186.2	118 ~ 150	114.8	45.2	32.5

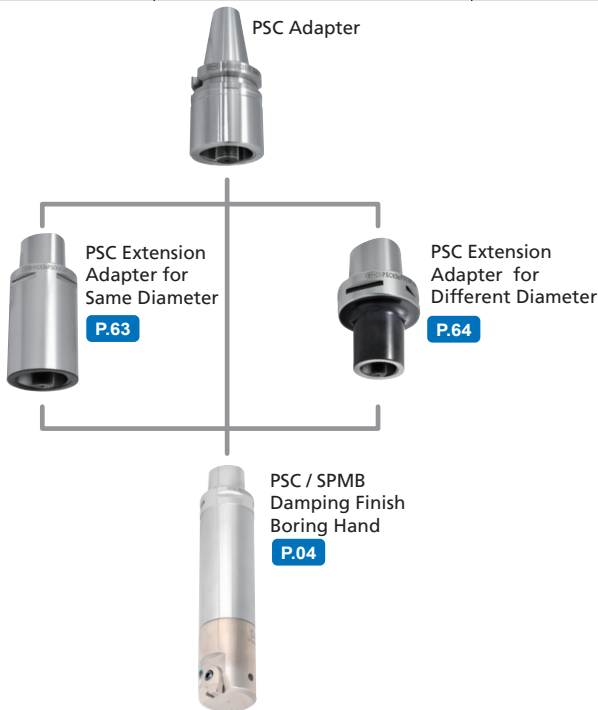

TYPES FOR INSERT SEAT:

TYPE	DRAWING	SUITABLE FINISH BORING HEAD	INSERT	
SIC32 - 1		SPMB32	TB06 / TP08	
SIC32 - 2			TP09 / TC11	
SIC32 - 3				
SIC41 - 1				SPMB41
SIC41 - 2				
SIC41 - 3				
SIC53 - 1	SPMB53		TP09 / TC11	
SIC53 - 2				
SIC53 - 3				
SIC68 - 1		SPMB68	TP09 / TC11	
SIC68 - 2				
SIC68 - 3				
SIC32 - 1E			SPMB32	TB06 / TP08
SIC32 - 2E				
SIC32 - 3E				
SIC41 - 1E			SPMB41	TP09 / TC11
SIC41 - 2E				
SIC41 - 3E				
SIC53 - 1E		SPMB53	TP09 / TC11	
SIC53 - 2E				
SIC53 - 3E				
SIC68 - 1E		SPMB68	TP09 / TC11	
SIC68 - 2E				
SIC68 - 3E				

STANDARD INSERT SEAT	OPTIONAL INSERT SEAT	
SIC32 - 1	SIC32 - 2	SIC32 - 3
φ 32 ~ φ 42	φ 41 ~ φ 51	φ 50 ~ φ 60



APPLICATION DIAGRAM



MCK Boring Head Shank
P.09

For adapters, please refer to

Adapter	Page
BT / MCK	P.32~36
CAT / MCK	P.37
DAT / MCK	P.38
SBT / MCK	P.39~42
SCAT / MCK	P.43
SDAT / MCK	P.44
HSK / MCK	P.45~46
PSC / MCK	P.47~48



MCK Extension Spacer
P.51



SLBK Damping Extension Spacer
P.08

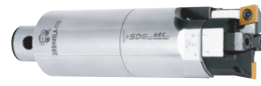

SRBH-LA Damping Twin-Bit Rough Boring Head
P.06



SCBH Damping Finish Boring Head
P.07



SCK Rough Boring Head
P.12



SMU Black Knight Finish Boring Head
P.13



SMB Finish Boring Head
P.14



SBJ Finish Boring Head
P.15



RBH-LA Indexable Twin-Bit Rough Boring Head
P.21



CBH Finish Boring Head
P.22



MBH Finish Boring Head
P.23



CBI Small Diameter Finish Boring Head
P.24



BYB Finish Boring Head Body
P.20



BT / CK Damping Boring Head Shank
P.09

SRBH-LA DAMPING TWIN-BIT ROUGH BORING HEAD

SRBH-LA 抑震雙刃搪孔頭

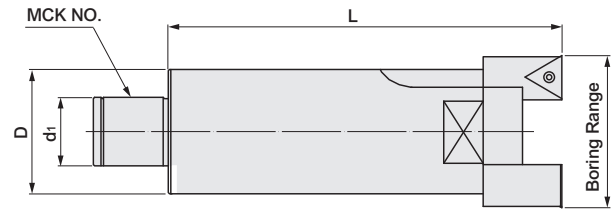

MODEL NO.	TYPE	MCK NO.	BORING RANGE	L	D	d ₁	INSERT	WEIGHT (KGS)
158.807.25.090	SRBH25LA - 90	MCK2	25 ~ 35	90	24	14	CC..0602	0.22
158.807.32.100	SRBH32LA - 100	MCK3	32 ~ 45	100	31	18	CC..0602, TC..1102	0.39
158.807.40.110	SRBH40LA - 110	MCK4	40 ~ 55	110	39	22	CC..09T3, TC..16T3	0.71
158.807.52.140	SRBH52LA - 140	MCK5	52 ~ 75	140	50	28	CC..09T3, TC..16T3	1.27
158.807.68.175	SRBH68LA - 175	MCK6	68 ~ 100	175	64	36	CC..1204, TC..16T3	6.20

ACCESSORIES

INSERT	CLAMPING SCREW	WRENCH
CC..0602	M2.5-6.0-3.5-60	T8
CC..09T3	M4-10-5.7-60	T15
CC..1204	M5-11-7.5-60	T20
TC..1102	M2.5-6.0-3.5-60	T8
TC..16T3	M4-10-5.7-60	T15

Features:

- ▶ The integrated structure of damper and boring head, it can combined with MCK arbor, and get wider effective length and better surface accuracy.
- ▶ With many specification from $\phi 25 \sim \phi 100$, all with the function of coolant through spindle.
- ▶ Use bilateral symmetry joint to enforce anti-vibration effect.
- ▶ 4D~8D deep machining has the best effect.
- ▶ Compare "the SRBH-LA dampened boring head" and "the SLBK dampened extension combined with RBH-LA boring head", the SRBH-LA can use in higher cutting feed rate to get better machining efficiency.



SCBH DAMPING FINISH BORING HEAD

SCBH 抑震精密微調搪孔頭

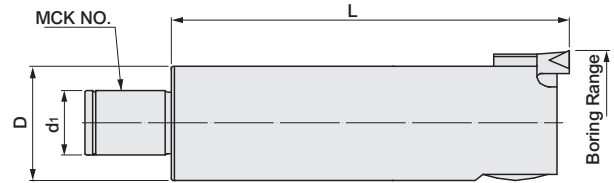

MODEL NO.	TYPE	MCK NO.	BORING RANGE	L	D	d ₁	INSERT	WEIGHT (KGS)
158.806.20.090	SCBH20 - 90	MCK1	20 ~ 26	90	19	11	TP.08	0.22
158.806.25.090	SCBH25 - 90	MCK2	25 ~ 33	90	24	14	TP.08	0.39
158.806.32.100	SCBH32 - 100	MCK3	32 ~ 42	100	31	18	TP.08	0.71
158.806.40.110	SCBH40 - 110	MCK4	40 ~ 55	110	39	22	TP.08	1.27
158.806.52.140	SCBH52 - 140	MCK5	52 ~ 75	140	50	28	TP.08	2.72
158.806.68.175	SCBH68 - 175	MCK6	68 ~ 102	175	64	36	TP.08, TP.09, TC..11	5.70

ACCESSORIES

INSERT	CLAMPING SCREW	WRENCH
TP.08	M2-5.0-2.7-60	T6
TP.09	M2.5-6.0-3.5-60	T8
TC..1102	M2.5-6.0-3.5-60	T8

Features:

- ▶ The integrated structure of damper and boring head, it can combined with MCK arbor, and get wider effective length and better surface accuracy.
- ▶ With many specification from $\phi 20 \sim \phi 102$, all with the function of coolant through spindle.
- ▶ Use bilateral symmetry joint to enforce anti-vibration effect.
- ▶ 4D~8D deep machining has the best effect.
- ▶ Compare "the SCBH dampened boring head" and "the SLBK dampened extension combined with CBH boring head", the SCBH can use in higher cutting feed rate to get better machining efficiency.

SLBK DAMPING EXTENSION SPACER

SLBK 抑震延長桿



SDG **KPZ**
SILENT DAMPING GENIUS

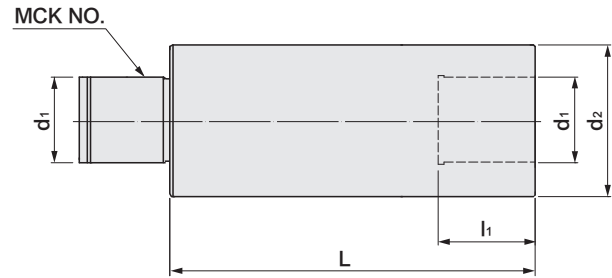

MODEL NO.	TYPE	MCK NO.	L	l ₁	d ₁	d ₂	WEIGHT (KGS)
158.808.0202.075	SLBK2 - 2 - 75	MCK2	75	18	14	24	0.33
158.808.0303.100	SLBK3 - 3 - 100	MCK3	100	22	18	31	0.62
158.808.0404.110	SLBK4 - 4 - 110	MCK4	110	26	22	39	1.11
158.808.0505.130	SLBK5 - 5 - 130	MCK5	130	32	28	50	2.30
158.808.0606.170	SLBK6 - 6 - 170	MCK6	170	42	36	64	5.10

Features:

- ▶ The integrated structure of damper and extension, it can combined with MCK arbor, and get wider effective length and better surface accuracy.
- ▶ With many specification from LBK2~LBK6, all with the function of coolant through spindle.
- ▶ Use bilateral symmetry joint to enforce anti-vibration effect.
- ▶ 4D~7D deep machining has the best effect.



BT / CK DAMPING BORING HEAD SHANK



BT / CK 抑震搪孔刀柄



PAT.NO : M505356
PAT.NO : M510806
ZL201520282217.6
ZL201520282261.7

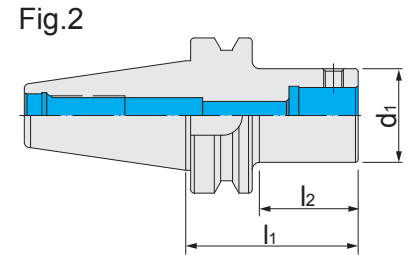
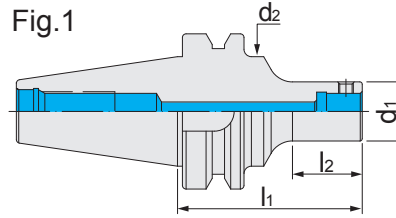

6 TIMES LONGER

MODEL NO.	TYPE	l_1	l_2	d_1	d_2	Fig.
11.66.02.150	BT40 × CK2DP - 150	150	110	24	39	1
11.66.03.200	BT40 × CK3DP - 200	200	160	31	50	1
11.66.04.235	BT40 × CK4DP - 235	235	200	39	50	1
11.66.05.310	BT40 × CK5DP - 310	310	280	50	-	2
11.66.06.295	BT40 × CK6DP - 295	295	270	64	-	2
12.66.02.160	BT50 × CK2DP - 160	160	110	24	39	1
12.66.03.220	BT50 × CK3DP - 220	220	160	31	50	1
12.66.04.260	BT50 × CK4DP - 260	260	205	39	64	1
12.66.05.310	BT50 × CK5DP - 310	310	265	50	64	1
12.66.06.375	BT50 × CK6DP - 375	375	330	64	-	2

8 TIMES LONGER

11.66.02.200	BT40 × CK2DP-200	200	160	24	39	1
11.66.03.260	BT40 × CK3DP-260	260	220	31	50	1
11.66.04.315	BT40 × CK4DP-315	315	280	39	50	1
12.66.02.210	BT50 × CK2DP-210	210	160	24	39	1
12.66.03.280	BT50 × CK3DP-280	280	220	31	50	1
12.66.04.340	BT50 × CK4DP-340	340	285	39	64	1
12.66.05.400	BT50 × CK5DP-400	400	355	50	64	1
12.66.06.505	BT50 × CK6DP-505	505	460	64	-	2

Features:

- ▶ The best efficiency will be reflected by machining with 4D~8D.
- ▶ Center through coolant supply is available.
- ▶ The bilateral symmetry joint allows for almost zero vibration.

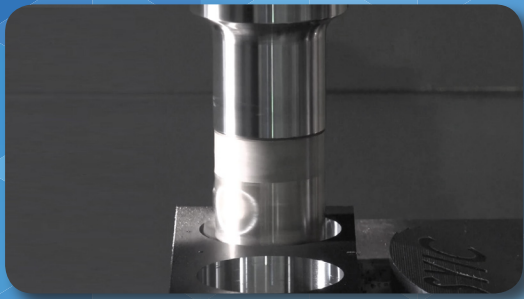

ROUGH & FINISH BORING HEAD

ROUGHING TWIN ADJUSTMENT BORING HEAD	P.12
SMU BLACK KNIGHT FINISH BORING HEAD	P.13
SUPER MICRON EXCHANGEABLE FINISH BORING HEAD	P.14
SBJ BORING HEAD FOR FINISHING	P.15
SLEEVE FOR TUNGSTEN STEEL TOOL HOLDER	P.15
SBE EXTENDED BORING INSERT SEAT	P.16
ANTI-VIBRANT TUNGSTEN STEEL TOOL HOLDER	P.17
THROW - AWAY BORING HEAD	P.18
SBJ BORING CUTTER	P.19
BYB BORING HEAD	P.20
BYB FINISH BORING HEAD BODY	P.20
RBH-LA INDEXABLE TWIN-BIT ROUGH BORING HEAD	P.21
CBH FINISH BORING HEAD	P.22
MBH FINISH BORING HEAD	P.23
CBI SMALL DIAMETER FINISH BORING HEAD	P.24
SRW ROUGHING BORING HEAD (OVER 150mm)	P.25
SMB SUPER MICRON EXCHANGEABLE FINISH BORING HEAD (OVER 150mm)	P.26
PSC / PMB FINISH BORING HEAD	P.27
PSC / PCK ROUGH BORING HEAD	P.28
PSC / PBJ FINISH BORING HEAD	P.28

APPLICATION DIAGRAM



MCK Boring Head Shank
P.09

For adapters, please refer to

Adapter	Page
BT / MCK	P.32~36
CAT / MCK	P.37
DAT / MCK	P.38
SBT / MCK	P.39~42
SCAT / MCK	P.43
SDAT / MCK	P.44
HSK / MCK	P.45~46
PSC / MCK	P.47~48

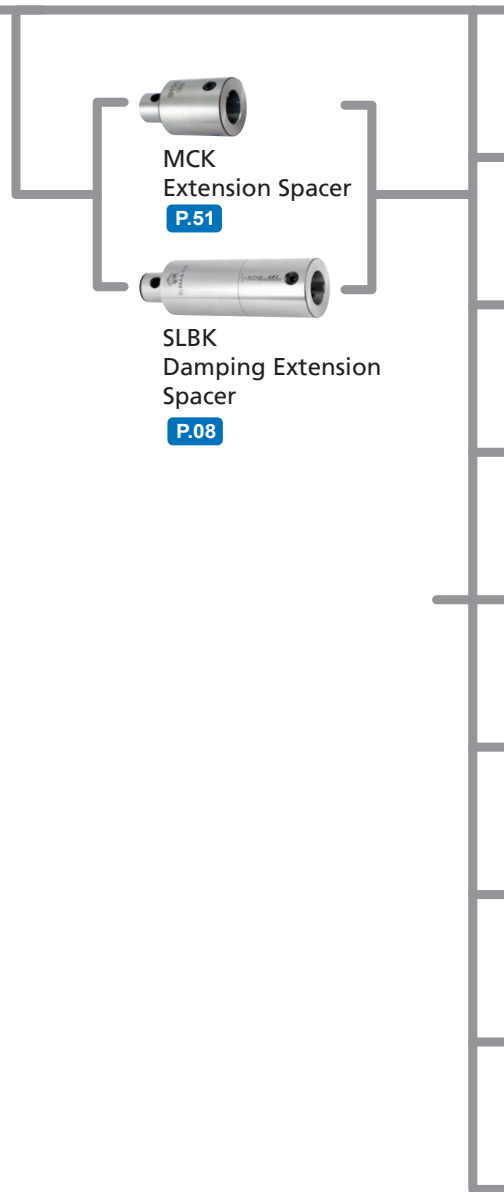

MCK Extension Spacer
P.51



SLBK Damping Extension Spacer
P.08



SCK Rough Boring Head
P.12



SMU Black Knight Finish Boring Head
P.13



SMB Finish Boring Head
P.14



SBJ Finish Boring Head
P.15



RBH-LA Indexable Twin-Bit Rough Boring Head
P.21



CBH Finish Boring Head
P.22



MBH Finish Boring Head
P.23



CBI Small Diameter Finish Boring Head
P.24



BYB Finish Boring Head
P.20



PSC Adapter

For adapters, please refer to

Adapter	Page
BT / PSC	P.55
CAT / PSC	P.57
DAT / PSC	P.58
SBT / PSC	P.59
SCAT / PSC	P.60
SDAT / PSC	P.61
HSK / PSC	P.62

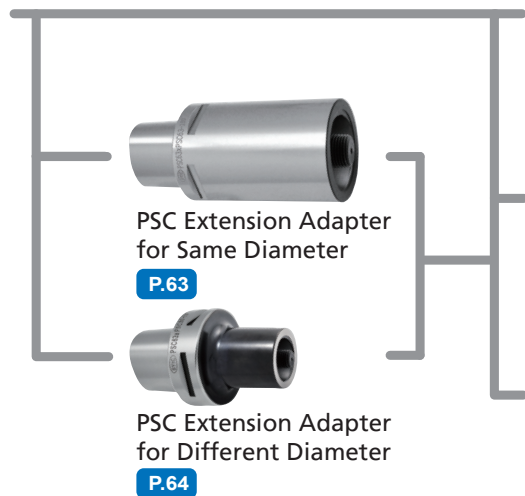

PSC Extension Adapter for Same Diameter
P.63



PSC Extension Adapter for Different Diameter
P.64



PSC / PMB Finish Boring Head
P.27



PSC / PCK Rough Boring Head
P.28



PSC / PBJ Finish Boring Head
P.28

ROUGHING TWIN ADJUSTMENT BORING HEAD

SCK 可調整式雙刃粗搪孔頭



台灣精品 2008
TAIWAN EXCELLENCE

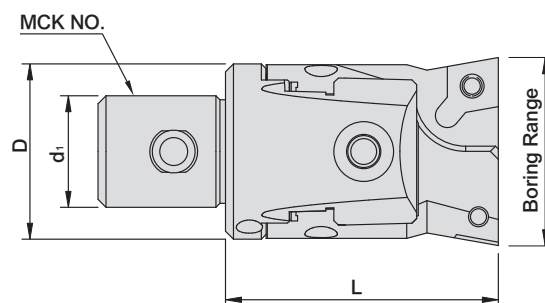

MODEL NO.	TYPE	MCK NO.	BORING RANGE		d ₁	L	D	INSERT	WEIGHT (KGS)
			MIN.	MAX.					
17602	SCK2430 - C	MCK2	24	30	14	34	22	CC..0602	0.19
17604	SCK2940 - C	MCK2	29	40	14	42	27	CC..09T3	0.19
17606	SCK3950 - C	MCK3	39	50	18	45	32	CC..09T3	0.19
17608	SCK4965 - C	MCK4	49	65	22	56	42	CC..1204	0.10
17612	SCK6382 - C	MCK5	63	82	28	66	54	CC..1204	0.20
17614	SCK80102 - C	MCK6	80	102	36	86	68	CC..1204	2.30

ACCESSORIES

INSERT	CLAMPING SCREW	WRENCH
CC..0602	M2.5-6.45-3.7	T8
CC..09T3	M4-10-5.7-60	T15
CC..1204	M5-11-7.5-60	T20

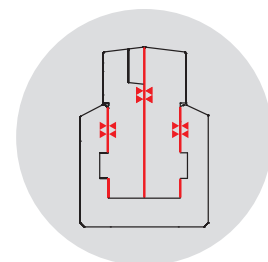

Features:

- ▶ When adjusting the boring diameter, two insert seats move simultaneously, saving time and increasing efficiency.
- ▶ The inserts seat make 3 face contacts with the boring head, improving the overall rigidity.
- ▶ Suitable for bigger table feed (F) with higher efficiency than competitors
- ▶ Suitable for rough, heavy-duty and interrupted boring.

Product information:

- ▶ Inserts are optional accessories. Needs to be purchased additionally.



SMU BLACK KNIGHT FINISH BORING HEAD

SMU 黑武士精搪頭



T W PAT NO. M500637
D E PAT NO. Nr.202015103584

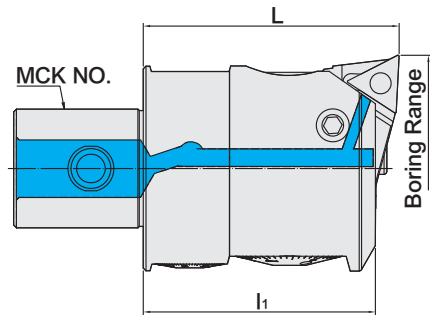

MODEL NO.	TYPE	MCK NO.	BORING AND PROCESSING AT FRONT			INSERT	WEIGHT (KGS)
			BORING RANGE	L	l ₁		
19590	SMU32	MCK3	32 ~ 42	40	37	TC..1102	0.20
19591	SMU41	MCK4	41 ~ 54	47	43	TC..1102	0.40
19592	SMU53	MCK5	53 ~ 70	57	53	TC..1102	0.80
19593	SMU68	MCK6	68 ~ 100	71	67	TC..1102	1.65

ACCESSORIES

INSERT	CLAMPING SCREW	WRENCH
TC..1102	M2.5-6.0-3.5-60	T8

Features:

- ▶ Micrometric adjustment on the diameters.
- ▶ Exchangeable insert seat is easy and convenient for replacement.
- ▶ Balancing adjustments can be made by users.
- ▶ Special surface structure to absorb shock and drain external water away.
- ▶ Surface treatment of matte finish for anti-glare and acid corrosion prevention.
- ▶ Available with MCK and CK connection.
- ▶ SMU is designed to have a coolant hole, which can remove the metal chips effectively and it's durable for coolant pressure up to 1,300 PSI.

Product information:

- ▶ Inserts are optional accessories. Needs to be purchased additionally.

SUPER MICRON EXCHANGEABLE FINISH BORING HEAD

SMB 超微米搪孔頭

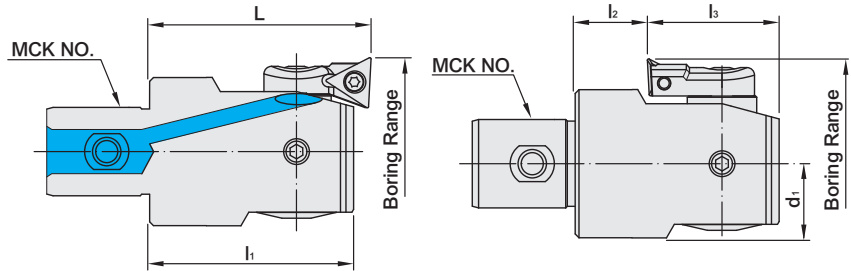

1 division=10μm

MODEL NO.	TYPE	MCK NO.	BORING AND PROCESSING AT FRONT			BORING AND PROCESSING AT BACK				WEIGHT (KGS)
			BORING RANGE	L	l ₁	BORING RANGE	l ₂	l ₃	d ₁	
19502	SMB20	MCK1	20 ~ 26	32.5	29.5	-	10.5	19.5	10	0.07
			25 ~ 31	32.5	29.5	30 ~ 31	10.5	19.5	10	0.07
			30 ~ 36	32.5	29.5	30 ~ 36	10.5	19.5	10	0.07
19503	SMB25	MCK2	25 ~ 33	35.5	32.5	-	11.5	21	12.5	0.12
			32 ~ 40	35.5	32.5	36 ~ 40	11.5	21	12.5	0.12
			39 ~ 47	35.5	32.5	39 ~ 47	11.5	21	12.5	0.12
19505	SMB32	MCK3	32 ~ 42	40	35	-	10	25	16	0.21
			41 ~ 51	40	35	46 ~ 51	10	25	16	0.21
			50 ~ 60	40	35	50 ~ 60	10	25	16	0.21
19507	SMB41	MCK4	41 ~ 54	47	43	-	14	29	20	0.40
			50 ~ 63	47	43	53 ~ 63	14	29	20	0.40
			61 ~ 74	47	43	61 ~ 74	14	29	20	0.40
19509	SMB53	MCK5	53 ~ 70	57	53	62 ~ 70	19	34	25.5	1.10
			65 ~ 82	57	53	65 ~ 82	19	34	25.5	1.10
			78 ~ 95	57	53	78 ~ 95	19	34	25.5	1.10
19511	SMB68	MCK6	68 ~ 100	71	67.2	80 ~ 100	22	45.2	32.5	1.74
			94 ~ 126	71	67.2	94 ~ 126	22	45.2	32.5	1.74
			118 ~ 150	71	67.2	118 ~ 150	22	45.2	32.5	1.74
19513	SMB100	MCK6	100 ~ 153	71	67.2	112 ~ 153	22	45.2	45.5	2.46
			126 ~ 179	71	67.2	126 ~ 179	22	45.2	45.5	2.46
			150 ~ 203	71	67.2	150 ~ 203	22	45.2	45.5	2.46

TYPES FOR INSERT SEAT:

TYPE	DRAWING	SUITABLE FINISH BORING HEAD	INSERT	TYPE	DRAWING	SUITABLE FINISH BORING HEAD	INSERT
SIC20 - 1		SMB20	TB06 / TP08	SIC20 - 1E		SMB20	TB06 / TP08
SIC20 - 2				SIC20 - 2E			
SIC20 - 3				SIC20 - 3E			
SIC25 - 1		SMB25	TB06 / TP08	SIC25 - 1E		SMB25	TB06 / TP08
SIC25 - 2				SIC25 - 2E			
SIC25 - 3				SIC25 - 3E			
SIC32 - 1		SMB32	TB06 / TP08	SIC32 - 1E		SMB32	TB06 / TP08
SIC32 - 2				SIC32 - 2E			
SIC32 - 3				SIC32 - 3E			
SIC41 - 1		SMB41	TP09 / TC11	SIC41 - 1E		SMB41	TP09 / TC11
SIC41 - 2				SIC41 - 2E			
SIC41 - 3				SIC41 - 3E			
SIC53 - 1		SMB53	TP09 / TC11	SIC53 - 1E		SMB53	TP09 / TC11
SIC53 - 2				SIC53 - 2E			
SIC53 - 3				SIC53 - 3E			
SIC68 - 1		SMB68 / SMB100	TP09 / TC11	SIC68 - 1E		SMB68 / SMB100	TP09 / TC11
SIC68 - 2				SIC68 - 2E			
SIC68 - 3				SIC68 - 3E			

For example: there are different boring ranges for different insert seats of SMB25.

- ▶ SYIC_-1 insert seat is a standard accessory.
- ▶ SYIC_-2 and SYIC_-3 insert seats are optional accessories and need to be purchased additionally.

Product information:

- ▶ Inserts are optional accessories. Needs to be purchased additionally.

STANDARD INSERT SEAT	OPTIONAL INSERT SEAT	
SIC25 - 1	SIC25 - 2	SIC25 - 3
φ 25 ~ φ 33	φ 32 ~ φ 40	φ 39 ~ φ 47



SBJ BORING HEAD FOR FINISHING

SBJ 高精密搪孔頭

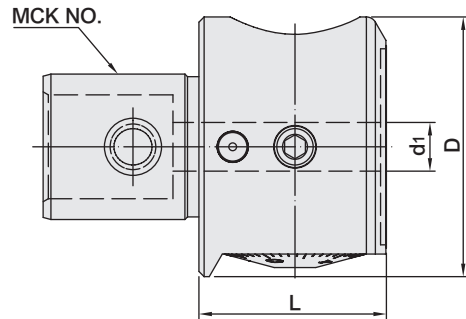

1 division=10 μ m

MODEL NO.	TYPE	MCK NO.	BORING RANGE	L	D	d ₁	WEIGHT (KGS)
19522	SBJ10	MCK4	6 - 22	28.5	39	10	0.25
19524	SBJ12	MCK5	6 - 32	36	50	12	0.50
19526	SBJ16	MCK6	6 - 50	45	63.5	16	1.00

Product information:

- ▶ Can choose the shank for boring head fit for the machine spindle.
- ▶ Boring head only, not including shank and cutter.

SLEEVE FOR TUNGSTEN STEEL TOOL HOLDER

鎢鋼刀柄專用套筒

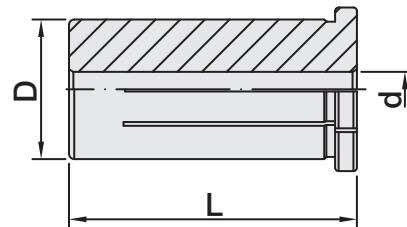

MODEL NO.	TYPE	L	D	d	WEIGHT (KGS)
82790 - 4	SBJ - 10 - 4K	30	10	4	0.01
82790 - 6	SBJ - 10 - 6K	30	10	6	0.01
82790 - 8	SBJ - 10 - 8K	30	10	8	0.01
82791 - 4	SBJ - 12 - 4K	35	12	4	0.01
82791 - 6	SBJ - 12 - 6K	35	12	6	0.01
82791 - 8	SBJ - 12 - 8K	35	12	8	0.01
82791 - 10	SBJ - 12 - 10K	35	12	10	0.01
82792	SBJ - 16 - 8K	37	16	8	0.08
82794	SBJ - 16 - 10K	37	16	10	0.04
82796	SBJ - 16 - 12K	37	16	12	0.02
82798	SBJ - 16 - 14K	37	16	14	0.01

SBE EXTENDED BORING INSERT SEAT

SBE 延伸搪孔刀座



台湾精品 2013
TAIWAN EXCELLENCE



T W PAT NO. M378059
T W PAT NO. M378058
T W PAT NO. M446035
J P PAT NO. 3159159
J P PAT NO. 3183047
C N PAT NO. ZL201220574428.3
D E PAT NO. Nr.202010000051.3
U S PAT NO. US9156091 B2

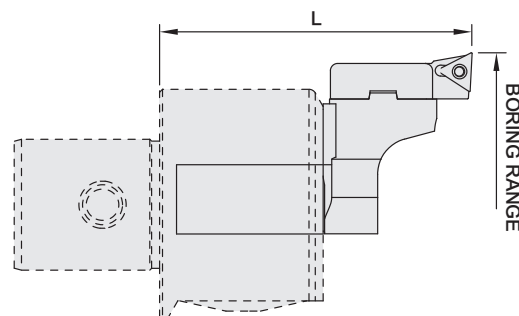

MODEL NO.	TYPE	SBJ NO.	INSERT SEAT	INSERT	BORING AND PROCESSING AT FRONT		WEIGHT (KGS)
					BORING RANGE	L	
158.684.0	SBE - 0	SBJ16	SIC53 - 1	TP09 / TC11	48 - 60	127	0.16
				TP09 / TC11	60 - 72	127	0.16
				TP09 / TC11	72 - 85	127	0.16
158.684.1	SBE - 1	SBJ16	SIC68 - 1	TP09 / TC11	84 - 96	85.5	0.18
				TP09 / TC11	95 - 107	85.5	0.18
158.684.2	SBE - 2	SBJ16	SIC68 - 2	TP09 / TC11	120 - 132	86	0.18
				TP09 / TC11	145 - 157	85.5	0.18
				TP09 / TC11	130 - 142	85.5	0.20
158.684.3	SBE - 3	SBJ16	SIC68 - 2	TP09 / TC11	156 ~ 168	86	0.20
				TP09 / TC11	180 ~ 192	85.5	0.20
				TP09 / TC11	142 ~ 154	85.5	0.24
158.684.4	SBE - 4	SBJ16	SIC68 - 3	TP09 / TC11	168 ~ 180	86	0.24
				TP09 / TC11	192 ~ 202	85.5	0.24
				TP09 / TC11			

ACCESSORIES

INSERT	CLAMPING SCREW	WRENCH
TP..0902	M2.5-6.0-3.5-60	T8
TC..1102	M2.5-6.0-3.5-60	T8

TYPES FOR INSERT SEAT:

INSERT	DRAWING	INSERT	DRAWING
SIC53 - 1		SIC53 - 1E	
SIC68 - 1		SIC68 - 1E	
SIC68 - 2		SIC68 - 2E	
SIC68 - 3		SIC68 - 3E	

SBJ16 BORING HEAD

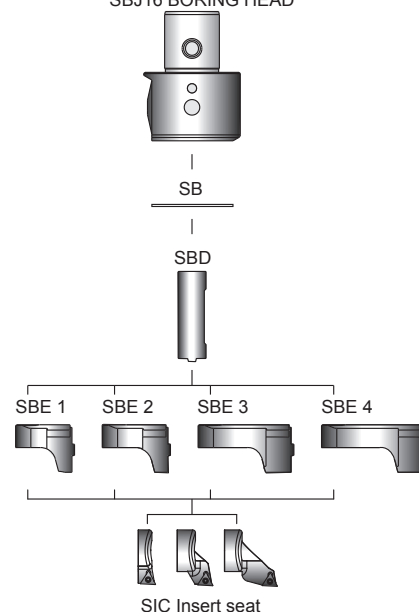

Features:

- ▶ Depending on the range of work piece's diameter, using SBE Extended Boring Insert Seat to enlarge the range of processing and can solve the difficulty of processing different work piece's diameter.
- ▶ To enlarge the range of processing it is easy to operate by only exchanging the insert seat.
- ▶ According to different processing material, operators choose suitable inserts which can increase precision, stability, and have excellent metal chips removal capability.
- ▶ Suitable for SBJ-16(SYIC-19526).
- ▶ Tool holders, SBJ Boring head for finishing, and Inserts need to be purchased additionally.

Product information:

- ▶ Inserts are optional accessories. Needs to be purchased additionally.



ANTI-VIBRANT TUNGSTEN STEEL TOOL HOLDER

抗震鎢鋼刀柄

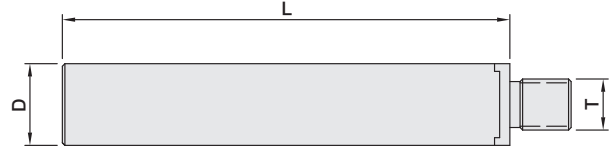

MODEL NO.	TYPE	D	L	T	SUITABLE BORING HEAD	BORING CAPACITY	WEIGHT (KGS)
82712	ST08 - W5 - 100L	8	100	M5	SEB09N	9mm ~ 13mm	0.08
82714	ST10 - W6 - 110L	10	110	M6	SEB12N	12mm ~ 15mm	0.12
82716	ST12 - W6 - 120L	12	120	M6	SEB14N	14mm ~ 17mm	0.21
82718	ST14 - W6 - 160L	14	160	M6	SEB16N	16mm ~ 20mm	0.34
82719	ST16 - W10 - 160L	16	160	M10	SEB18N ~ SEB40N	18mm ~ 42mm	0.45

Features:

- ▶ Boring hole in depth can't exceed 6 times of hole diameter.

THROW - AWAY BORING HEAD

捨棄式搪頭

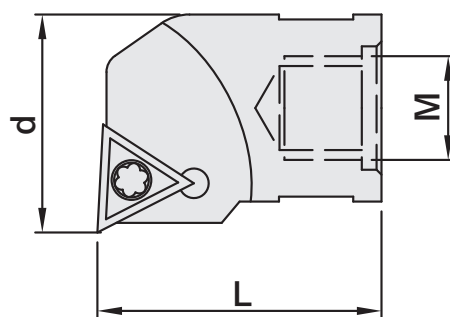

MODEL NO.	TYPE	BORING CAPACITY	d	L	M	INSERTS	SCREW	WRENCH	WEIGHT (KGS)
82732	SEB09N - TP08	9 - 10.5	9	18	M5	TP..0802	M2-5.0-2.7-60	T6	0.02
82732 - 10.5 - TP08	SEB10.5N - TP08	10.5 - 12	10.5	18	M5	TP..0802	M2-5.0-2.7-60	T6	0.02
82733	SEB12N - TP08	12 - 14	12	23	M6	TP..0802	M2-5.0-2.7-60	T6	0.02
82734	SEB14N - TP08	14 - 16	14	23	M6	TP..0802	M2-5.0-2.7-60	T6	0.02
82735	SEB16N - TP08	16 - 18	16	23	M6	TP..0802	M2-5.0-2.7-60	T6	0.03
82736	SEB18N - TP08	18 - 20	18	27	M10	TP..0802	M2-5.0-2.7-60	T6	0.03
82737	SEB20N - TP08	20 - 22	20	27	M10	TP..0802	M2-5.0-2.7-60	T6	0.04
82738	SEB22N - TP08	22 - 24	22	27	M10	TP..0802	M2-5.0-2.7-60	T6	0.04
82739	SEB24N - TP08	24 - 26	24	27	M10	TP..0802	M2-5.0-2.7-60	T6	0.04
82740	SEB26N - TP08	26 - 28	26	27	M10	TP..0802	M2-5.0-2.7-60	T6	0.04
82741	SEB28N - TP08	28 - 30	28	27	M10	TP..0802	M2-5.0-2.7-60	T6	0.04
82742	SEB30N - TP08	30 - 32	30	27	M10	TP..0802	M2-5.0-2.7-60	T6	0.04
82743	SEB32N - TP08	32 - 34	32	27	M10	TP..0802	M2-5.0-2.7-60	T6	0.04
82744	SEB34N - TP08	34 - 36	34	27	M10	TP..0802	M2-5.0-2.7-60	T6	0.05
82745	SEB36N - TP08	36 - 38	36	27	M10	TP..0802	M2-5.0-2.7-60	T6	0.04
82746	SEB38N - TP08	38 - 40	38	27	M10	TP..0802	M2-5.0-2.7-60	T6	0.05
82747	SEB40N - TP08	40 - 42	40	27	M10	TP..0802	M2-5.0-2.7-60	T6	0.05
82748	SEB42N - TP08	42 - 44	42	27	M10	TP..0802	M2-5.0-2.7-60	T6	0.05
82749	SEB44N - TP08	44 - 46	44	27	M10	TP..0802	M2-5.0-2.7-60	T6	0.05
82750	SEB46N - TP08	46 - 48	46	27	M10	TP..0802	M2-5.0-2.7-60	T6	0.05
82751	SEB48N - TP08	48 - 50	48	27	M10	TP..0802	M2-5.0-2.7-60	T6	0.05
82751 - 50 - TP08	SEB50N - TP08	50 - 52	50	27	M10	TP..0802	M2-5.0-2.7-60	T6	0.05
82732 - TB06	SEB09N - 06 - TB06	9 - 10.5	9	18	M5	TB..0601	M2-5.0-2.7-60	T6	0.02
82733 - TB06	SEB12N - 06 - TB06	12 - 14	12	23	M6	TB..0601	M2-5.0-2.7-60	T6	0.02
82734 - TP09	SEB14N - 09 - TP09	14 - 16	14	23	M6	TP..0902	M2.5-6.0-3.5-60	T8	0.02
82735 - TP09	SEB16N - 09 - TP09	16 - 18	16	23	M6	TP..0902	M2.5-6.0-3.5-60	T8	0.03
82736 - TP09	SEB18N - 09 - TP09	18 - 20	18	27	M10	TP..0902	M2.5-6.0-3.5-60	T8	0.03
82737 - TP09	SEB20N - 09 - TP09	20 - 22	20	27	M10	TP..0902	M2.5-6.0-3.5-60	T8	0.04
82738 - TP11	SEB22N - 11 - TP11	22 - 24	22	27	M10	TP..1103	M3-8.0-4.0-43	T9	0.04
82739 - TP11	SEB24N - 11 - TP11	24 - 26	24	27	M10	TP..1103	M3-8.0-4.0-43	T9	0.04
82740 - TP11	SEB26N - 11 - TP11	26 - 28	26	27	M10	TP..1103	M3-8.0-4.0-43	T9	0.04
82741 - TP11	SEB28N - 11 - TP11	28 - 30	28	27	M10	TP..1103	M3-8.0-4.0-43	T9	0.04
82742 - TP11	SEB30N - 11 - TP11	30 - 32	30	27	M10	TP..1103	M3-8.0-4.0-43	T9	0.04
82743 - TP11	SEB32N - 11 - TP11	32 - 34	32	27	M10	TP..1103	M3-8.0-4.0-43	T9	0.04
82744 - TP11	SEB34N - 11 - TP11	34 - 36	34	27	M10	TP..1103	M3-8.0-4.0-43	T9	0.05
82745 - TP11	SEB36N - 11 - TP11	36 - 38	36	27	M10	TP..1103	M3-8.0-4.0-43	T9	0.04
82746 - TP11	SEB38N - 11 - TP11	38 - 40	38	27	M10	TP..1103	M3-8.0-4.0-43	T9	0.05
82747 - TP11	SEB40N - 11 - TP11	40 - 42	40	27	M10	TP..1103	M3-8.0-4.0-43	T9	0.04

Product information:

- ▶ Inserts are optional accessories. Needs to be purchased additionally.



BORING CUTTER

INTERCHANGEABLE

替換式 搪孔刀

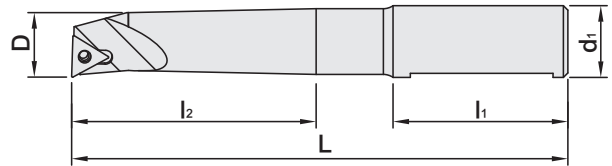

MODEL NO.	TYPE	BORING CAPACITY	D	d ₁	L	l ₁	l ₂	INSERTS	WEIGHT (KGS)
82372	SBJ - 1008 - 24	8 - 11	8	10	58	25	24	TB..0601	0.02
82374	SBJ - 1010 - 30	10 - 13	10	10	64	25	30	TB..0601	0.04
82376	SBJ - 1012 - 36	12 - 17	12	10	70	25	36	TP..0902	0.04
82378	SBJ - 1016 - 48	16 - 21	16	10	78	25	48	TP..0902	0.08
82380	SBJ - 10 4PCS / SET INCLUDE BOX								
82382	SBJ - 1208 - 28	8 - 11	8	12	67	30	28	TB..0601	0.04
82384	SBJ - 1210 - 35	10 - 13	10	12	74	30	35	TB..0601	0.04
82386	SBJ - 1212 - 42	12 - 17	12	12	81	30	42	TP..0902	0.06
82388	SBJ - 1216 - 56	16 - 21	16	12	95	30	56	TP..0902	0.08
82390	SBJ - 1220 - 70	20 - 26	20	12	105	30	70	TP..1103	0.12
82392	SBJ - 12 5PCS / SET INCLUDE BOX								
82752	SBJ - 1608 - 32	8 - 11	8	16	64	32	32	TB..0601	0.06
82754	SBJ - 1610 - 40	10 - 13	10	16	72	32	40	TB..0601	0.07
82756	SBJ - 1612 - 53	12 - 17	12	16	85	32	53	TP..0902	0.08
82758	SBJ - 1616 - 68	16 - 21	16	16	100	32	68	TP..0902	0.12
82760	SBJ - 1620 - 83	20 - 26	20	16	115	32	83	TP..1103	0.16
82762	SBJ - 1625 - 90	25 - 32	25	16	122	32	90	TP..1103	0.25
82764	SBJ - 1630 - 90	30 - 42	30	16	122	32	90	TP..1103	0.30
82766	SBJ - 1640 - 90	40 - 50	40	16	122	32	90	TP..1103	0.40
82768	SBJ - 16 8PCS / SET INCLUDE BOX								
82772	SBJ - 2008 - 32	8 - 11	8	20	64	32	32	TB..0601	0.09
82774	SBJ - 2010 - 40	10 - 13	10	20	72	32	40	TB..0601	0.11
82776	SBJ - 2012 - 53	12 - 17	12	20	85	32	53	TP..0902	0.11
82778	SBJ - 2016 - 68	16 - 21	16	20	100	32	68	TP..0902	0.15
82780	SBJ - 2020 - 83	20 - 26	20	20	115	32	83	TP..1103	0.20
82782	SBJ - 2025 - 96	25 - 135	25	20	128	32	96	TP..1103	0.30
82784	SBJ - 2030 - 115	30 - 140	30	20	147	32	115	TP..1103	0.50
82786	SBJ - 20 - 20L	280	40	20	97	-	-	TP..1103	0.25
82788	SBJ - 20 8PCS / SET INCLUDE BOX								

ACCESSORIES

INSERT	CLAMPING SCREW	WRENCH
TB..0601	M2-5.0-2.7-60	T6
TP..0902	M2.5-6.0-3.5-60	T9
TP..1103	M3-8.0-4.0-43	T9

Product information:

- ▶ Inserts are optional accessories. Needs to be purchased additionally.

BYB BORING HEAD

MICROMETER ADJUSTABLE

BYB 微切削搪孔頭

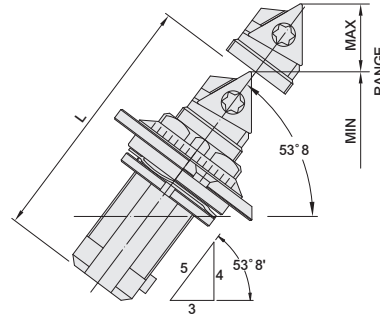

MODEL NO.	TYPE	RANGE		L	INSERT	SCREW	WRENCH	BYB BORING HEAD TYPE	WEIGHT (KGS)
		MIN.	MAX.						
17406	M2 - 19	19	22.5	20.7	TB..0601	M2-3.8-2.68-43	T6	M2 - 19	0.06
17408	M2 - 22	22	29.5	23.5	TB..0601	M2-3.8-2.68-43	T6	M2 - 19	0.06
17410	M3 - 29	29	41	31	TB..0601	M2-3.8-2.68-43	T6	M2 - 19	0.07
17412	M5 - 38	38	50	40	TP..1103	M2.5-7.5-4.3-60	T9	M2 - 22	0.08
17414	M5 - 48	48	65	47.7	TP..1103	M2.5-7.5-4.3-60	T9	M2 - 22	0.10
17416	M7 - 62	62	90	63.5	TP..16T3	M4-10-5.0-60	T15	M3 - 29	0.20

Product information:

► For the body of boring head, please refer to BYB FINISH BORING HEAD BODY. ► Inserts are optional accessories. Need to be purchased additionally.

BYB FINISH BORING HEAD BODY

BYB 微切削搪刀柄

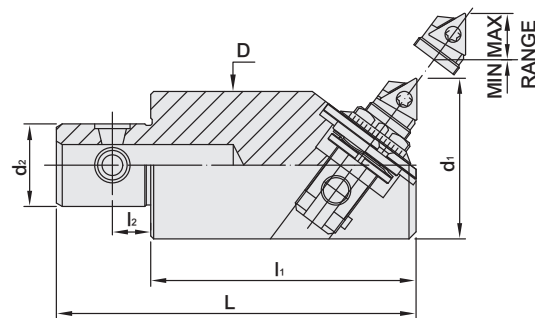

MODEL NO.	TYPE	ASSEMBLE TOOL HOLDER	d ₁		d ₂	L	l ₁	l ₂	D	WEIGHT (KGS)
			MIN.	MAX.						
17382	BYB19	MCK1	19	22.5	11	51	35	4.75	18	0.36
17384	BYB22	MCK1	22	29.5	11	51	35	4.75	20	0.36
17386	BYB29	MCK2	29	41	14	61	45	6.5	25	0.37
17388	BYB38	MCK3	38	50	18	90	70	7.7	35	0.41
17390	BYB48	MCK4	48	65	22	84	60	7.7	41	0.59
17392	BYB62	MCK5	62	90	28	110	80	12.7	54	0.70
17394	BYB82	MCK6	82	110	36	150	110	15.7	67	1.05

Product information:

► Only contains the body, not including BYB Micrometer Adjustable Boring Head.
 ► Inserts are optional accessories. Need to be purchased additionally.



RBH-LA INDEXABLE TWIN-BIT ROUGH BORING HEAD



RBH-LA 新型可調整式雙刀粗搪孔頭

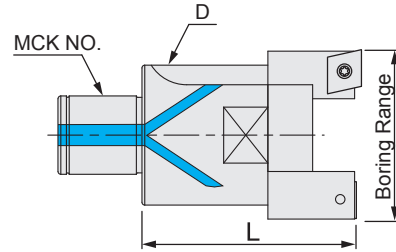

MODEL NO.	TYPE	MCK NO.	L	D	BORING RANGE	INSERT	WEIGHT (KGS)
158.617.25.CC06	RBH - 25-35LA - C	MCK2	50	24	25 ~ 35	CC..0602	0.18
158.617.32.CC06	RBH - 32-45LA - C	MCK3	60	31	32 ~ 45	CC..0602	0.34
158.617.32.TC11	RBH - 32-45LA - T	MCK3	60	31	32 ~ 45	TC..1102	0.35
158.617.40.CC09	RBH - 40-55LA - C	MCK4	74	39	40 ~ 55	CC..09T3	0.62
158.617.40.TC16	RBH - 40-55LA - T	MCK4	74	39	40 ~ 55	TC..16T3	0.61
158.617.52.CC09	RBH - 52-75LA - C	MCK5	80	50	52 ~ 75	CC..09T3	1.13
158.617.52.TC16	RBH - 52-75LA - T	MCK5	80	50	52 ~ 75	TC..16T3	1.11
158.617.68.CC12	RBH - 68-100LA - C	MCK6	90	66	68 ~ 100	CC..1204	2.20
158.617.68.TC16	RBH - 68-100LA - T	MCK6	90	66	68 ~ 100	TC..16T3	2.21
158.617.90.CC12	RBH - 90-130LA - C	MCK6	100	88	90 ~ 130	CC..1204	3.10
158.617.90.TC16	RBH - 90-130LA - T	MCK6	100	88	90 ~ 130	TC..16T3	2.99

ACCESSORIES

INSERT	CLAMPING SCREW	WRENCH
CC..0602	M2.5-6.0-3.5-60	T8
CC..09T3	M4-10-5.7-60	T15
CC..1204	M5-11-7.5-60	T20
TC..1102	M2.5-6.0-3.5-60	T8
TC..16T3	M4-10-5.7-60	T15

Features:

- ▶ Thickened cartridge with higher rigidity.
- ▶ RBH-25LA~RBH-160LA Coolant nozzle easily cools the insert elongating its working life.
- ▶ Completed with chip pocket, improving chip flow of deep boring.
- ▶ Clamp plate solidifies cartridges and head, upgrading cutting rigidity.
- ▶ Patented step boring design; suitable for both level boring and step boring.

CBH FINISH BORING HEAD



CBH 微調精搪孔頭

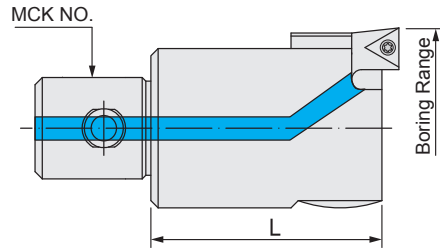

MODEL NO.	TYPE	MCK NO.	L	BORING RANGE	INSERT	Torque (N.m)	WEIGHT (KGS)
158.67.20.TB06	CBH20 - TB06	MCK1	35	20 ~ 26	TB..0601	0.6	0.19
158.67.25.TB06	CBH25 - TB06	MCK2	40	25 ~ 33	TB..0601	0.6	0.20
158.67.32.TB06	CBH32 - TB06	MCK3	40	32 ~ 42	TB..0601	0.6	0.28
158.67.40.TB06	CBH40 - TB06	MCK4	50	40 ~ 55	TB..0601	0.6	0.59
158.67.20.TP08	CBH20 - TP08	MCK1	35	20 ~ 26	TP..0802	0.6	0.19
158.67.25.TP08	CBH25 - TP08	MCK2	40	25 ~ 33	TP..0802	0.6	0.26
158.67.32.TP08	CBH32 - TP08	MCK3	40	32 ~ 42	TP..0802	0.6	0.37
158.67.40.TP08	CBH40 - TP08	MCK4	50	40 ~ 55	TP..0802	0.6	0.52
158.67.20.TC09	CBH20 - TC09	MCK1	35	20 ~ 26	TC..0902	0.6	0.19
158.67.25.TC09	CBH25 - TC09	MCK2	40	25 ~ 33	TC..0902	0.6	0.20
158.67.32.TC09	CBH32 - TC09	MCK3	40	32 ~ 42	TC..0902	0.6	0.37
158.67.40.TC09	CBH40 - TC09	MCK4	50	40 ~ 55	TC..0902	0.6	0.50
158.67.20.TP09	CBH20 - TP09	MCK1	35	20 ~ 26	TP..0902	1.2	0.10
158.67.25.TP09	CBH25 - TP09	MCK2	40	25 ~ 33	TP..0902	1.2	0.20
158.67.32.TP09	CBH32 - TP09	MCK3	40	32 ~ 42	TP..0902	1.2	0.30
158.67.40.TP09	CBH40 - TP09	MCK4	50	40 ~ 55	TP..0902	1.2	0.50
158.67.52.TP08	CBH52 - TP08	MCK5	60	52 ~ 75	TP..0802	0.6	1.02
158.67.68.TP08	CBH68 - TP08	MCK6	72	68 ~ 102	TP..0802	0.6	2.02
158.67.100.TP08	CBH100 - TP08	MCK6	72	100 ~ 152	TP..0802	0.6	2.90
158.67.150.TP08	CBH150 - TP08	MCK6	72	150 ~ 202	TP..0802	0.6	4.43
158.67.52.TP09	CBH52 - TP09	MCK5	60	52 ~ 75	TP..0902	1.2	1.00
158.67.68.TP09	CBH68 - TP09	MCK6	72	68 ~ 102	TP..0902	1.2	2.00
158.67.100.TP09	CBH100 - TP09	MCK6	72	100 ~ 152	TP..0902	1.2	3.16
158.67.150.TP09	CBH150 - TP09	MCK6	72	150 ~ 202	TP..0902	1.2	4.20
158.67.52.TC11	CBH52 - TC11	MCK5	60	52 ~ 75	TC..1102	1.2	1.00
158.67.68.TC11	CBH68 - TC11	MCK6	72	68 ~ 102	TC..1102	1.2	2.00
158.67.100.TC11	CBH100 - TC11	MCK6	72	100 ~ 152	TC..1102	1.2	2.90
158.67.150.TC11	CBH150 - TC11	MCK6	72	150 ~ 202	TC..1102	1.2	4.20

ACCESSORIES

INSERT	CLAMPING SCREW	WRENCH	INSERT	CLAMPING SCREW	WRENCH
TB..0601	M2-5.0-2.7-60	T6	TC..0902	M2-5.0-3.1-60	T6
TP..0802	M2-5.0-3.1-60	T6	TC..1102	M2.5-6.0-3.5-60	T8
TP..0902	M2.5-6.0-3.5-60	T8			

Features:

- ▶ Micro-adjustments with fifty 0.01mm in diameter. Includes a sub-dial for finer adjustments ranging from ϕ 20mm~ ϕ 202mm.
- ▶ T-type insert has a clearance angle of 3°.
- ▶ The insert seat spindle use square structure with two face support, proving high stability and rigidity on diameter.



MBH FINISH BORING HEAD



MBH 微調精搪孔頭

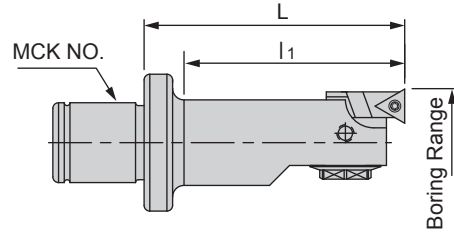

MODEL NO.	TYPE	MCK NO.	L	li	BORING RANGE	INSERT	TORQUE (N.M)	WEIGHT (KGS)
158.495.16A.WC02	MBH16A	MCK2	55	50	16 ~ 20	WC..02	0.6	0.09
158.495.16B.WC02	MBH16B	MCK2	80	75	16 ~ 20	WC..02	0.6	0.12

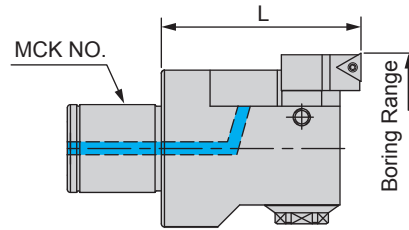

MODEL NO.	TYPE	MCK NO.	L	BORING RANGE	INSERT	Torque (N.m)	WEIGHT (KGS)
158.495.20.WC02	MBH20 - WC02	MCK1	35	20 ~ 26	WC..02	0.6	0.07
158.495.25.WC02	MBH25 - WC02	MCK2	40	25 ~ 32	WC..02	0.6	0.12
158.495.32.TP09	MBH32 - WC02	MCK3	40	32 ~ 42	TP..0902	1.2	0.23
158.495.32.TC09	MBH32 - TC09	MCK3	40	32 ~ 42	TC..0902	0.6	0.23
158.495.32.CC06	MBH32 - CC06	MCK3	40	32 ~ 42	CC..0602	1.2	0.23
158.495.40A	MBH40A	MCK4	50	40 ~ 55	TP..1103	1.4	0.43
158.495.40B	MBH40B	MCK4	50	55 ~ 70	TC..1102 CC..0602	1.2 1.2	0.43
158.495.52A	MBH52A	MCK5	60	52 ~ 70	TP..1103	1.4	0.90
158.495.52B	MBH52B	MCK5	60	67 ~ 85	TC..1102 CC..0602	1.2 1.2	0.90
158.195.68A	MBH68A	MCK6	75	68 ~ 88	TP..1103	1.4	1.86
158.195.68B	MBH68B	MCK6	75	85 ~ 105	TC..1102 CC..09T3	1.2 3.0	1.86

ACCESSORIES

INSERT	CLAMPING SCREW	WRENCH	INSERT	CLAMPING SCREW	WRENCH
WC..02	M2.0-5.0-2.7-60	T6	TC..1102	M2.5-6.0-3.5-60	T8
CC..0602	M2.5-6.0-3.5-60	T8	TP..0902	M2.5-6.0-3.5-60	T8
CC..09T3	M4-10-5.7-60	T15	TP..1103	M3-8.0-4.0-43	T9
TC..0902	M2-5.0-3.1-60	T6			

Product Information:

- ▶ Each of MBH40, MBH52, MBH68, MBH100, MBH140, MBH200, MBH300, MBH400, MBH500 is with both A and Binsert-holders for exchange on demand to obtain the maximum boring range.



CBI SMALL DIAMETER FINISH BORING HEAD



CBI 小徑微調精搪刀



PAT. NO 217175
 PAT. NO 221678
 PAT. NO ZL03276491.X
 PAT. NO ZL03208876.0

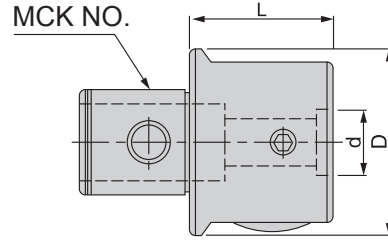

MODEL NO.	TYPE	MCK NO.	L	D	d	WEIGHT (KGS)
158.68.04	CBI4	MCK4	32	39	10	0.40
158.68.05	CBI5	MCK5	40	50	12	0.80
158.68.06	CBI6	MCK6	50	64	16	1.27

Features:

- ▶ Available are three different styles enabling small diameter boring from ϕ 8mm to ϕ 50mm. Boring range can be with in ϕ 3mm to ϕ 10mm if small diameter solid carbide boring bar has been employed.
- ▶ The dial has been graduated into 50 divisions, each of which is 0.01mm on diameter. Available is sub-dial for finer adjustment.
- ▶ High precision internal lead screw with inner lubrication is free from the effects of chip, featuring high durability.

CBI SMALL DIAMETER ADAPTER



CBI 小徑套筒

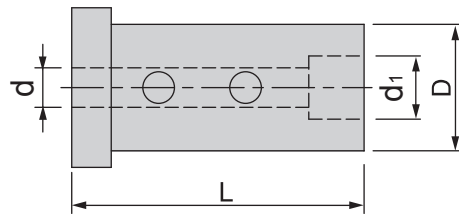

MODEL NO.	TYPE	L	D	d	d ₁	CLAMPING SCREW	WRENCH	TORQUE (N.M)	WEIGHT (KGS)
158.69.0416	SH-0416-37	37	16	4	8	HS4x4	PL2	3	0.07
158.69.0516	SH-0516-37	37	16	5	8	HS5x5.5	PL2	3	0.06
158.69.0616	SH-0616-37	37	16	6	8	HS6x4	PL2	3	0.06
158.69.0716	SH-0716-37	37	16	7	8	HS6x4	PL2	3	0.06



SRW ROUGHING BORING HEAD

SRW 大孔徑粗搪頭 (150mm 以上系列)



150mm
~
830mm

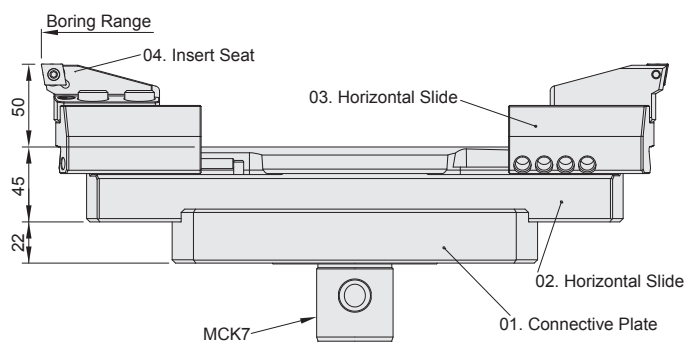

MODEL NO.	TYPE	BORING RANGE		01. CONNECTIVE PLATE	02. HORIZONTAL SLIDE	03. HORIZONTAL SLIDE	04. INSERT SEAT	WEIGHT (KGS)
		MIN.	MAX.					
19532	SRW 150A	150	200	SFL135	SSL150 - 200	SCB150 - 200	SRW150A	7.24
19534	SRW 200A	200	270	SFL135	SSL200 - 270	SCB200 - 550	SRW150A	8.85
19536	SRW 270A	270	340	SFL135	SSL270 - 340	SCB200 - 550	SRW150A	10.3
19538	SRW 340A	340	410	SFL135	SSL340 - 410	SCB200 - 550	SRW150A	11.8
19540	SRW 410A	410	480	SFL135	SSL410 - 480	SCB200 - 550	SRW150A	13.2
19542	SRW 480A	480	550	SFL135	SSL480 - 550	SCB200 - 550	SRW150A	14.7
19544	SRW 550A	550	620	SFL220	SSL550 - 620	SCB200 - 550	SRW150A	18.6
19546	SRW 620A	620	690	SFL220	SSL620 - 690	SCB200 - 550	SRW150A	20.1
19548	SRW 690A	690	760	SFL220	SSL690 - 760	SCB200 - 550	SRW150A	21.5
19550	SRW 760A	760	830	SFL220	SSL760 - 830	SCB200 - 550	SRW150A	22.9

ACCESSORIES

INSERT	CLAMPING SCREW	WRENCH
CC..1204	M5-11-7.5-60	T20

Features:

- ▶ Spare parts can be purchased individually.
- ▶ SERIES FOR OVER 150mm MANUFACTURING DIAMETER: ϕ 150mm ~ ϕ 830mm

Product information:

- ▶ Inserts are optional accessories. Needs to be purchased additionally.

SMB SUPER MICRON EXCHANGEABLE FINISH BORING HEAD

SMB 大孔徑粗搪頭 (150mm 以上系列)

150mm
~
830mm

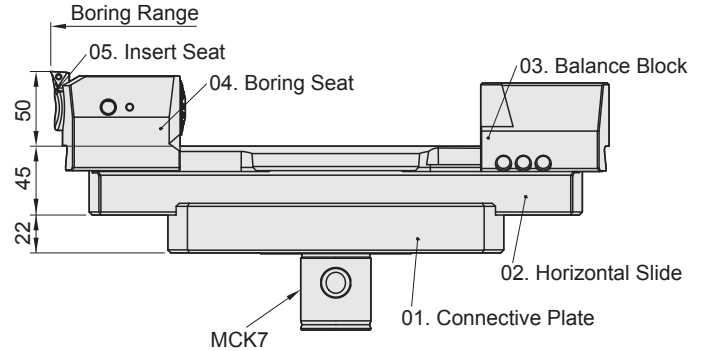

MODEL NO.	TYPE	01. CONNECTIVE PLATE	02. HORIZONTAL SLIDE	03. BALANCE BLOCK	04. BORING SEAT	05. INSERT SEAT	BORING RANGE	WEIGHT (KGS)
19562	SMB150	SFL135	SSL150~200	SWB150~200	SMB150L	SIC68-1	150~200	10.6
						SIC68-2	176~226	10.6
						SIC68-3	200~250	10.6
19564	SMB200	SFL135	SSL200~270	SWB200~550	SMB150L	SIC68-1	200~270	11.6
						SIC68-2	226~296	11.6
						SIC68-3	250~320	11.6
19566	SMB270	SFL135	SSL270~340	SWB200~550	SMB150L	SIC68-1	270~340	13.0
						SIC68-2	296~366	13.0
						SIC68-3	320~390	13.0
19568	SMB340	SFL135	SSL340~410	SWB200~550	SMB150L	SIC68-1	340~410	14.4
						SIC68-2	366~436	14.4
						SIC68-3	390~460	14.4
19570	SMB410	SFL135	SSL410~480	SWB200~550	SMB150L	SIC68-1	410~480	15.8
						SIC68-2	436~506	15.8
						SIC68-3	460~530	15.8
19572	SMB480	SFL135	SSL480~550	SWB200~550	SMB150L	SIC68-1	480~550	17.2
						SIC68-2	506~576	17.2
						SIC68-3	530~600	17.2
19574	SMB550	SFL220	SSL550~620	SWB200~550	SMB150L	SIC68-1	550~620	20.0
						SIC68-2	576~646	20.0
						SIC68-3	600~670	20.0
19576	SMB620	SFL220	SSL620~690	SWB200~550	SMB150L	SIC68-1	620~690	21.4
						SIC68-2	646~716	21.4
						SIC68-3	670~740	21.4
19578	SMB690	SFL220	SSL690~760	SWB200~550	SMB150L	SIC68-1	690~760	22.9
						SIC68-2	716~786	22.9
						SIC68-3	740~810	22.9
19580	SMB760	SFL220	SSL760~830	SWB200~550	SMB150L	SIC68-1	760~830	24.3
						SIC68-2	786~856	24.3
						SIC68-3	810~880	24.3

ACCESSORIES

INSERT	CLAMPING SCREW	WRENCH
TP.0902	M2.5-6.0-3.5-60	T8
TC..1102	M2.5-6.0-3.5-60	T8

TYPES FOR INSERT SEAT:

INSERT	DRAWING	INSERT	DRAWING
SIC68 - 1		SIC68 - 1E	
SIC68 - 2		SIC68 - 2E	
SIC68 - 3		SIC68 - 3E	



PSC / PMB FINISH BORING HEAD

ONE-PIECE TYPE

PSC / PMB 超微米精搪頭[一體式]

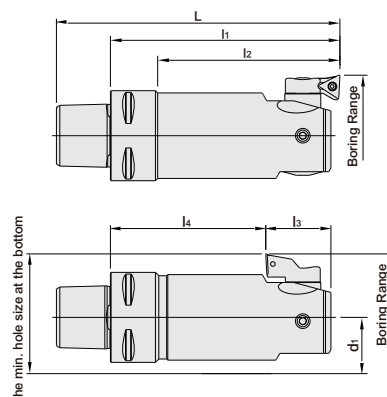

MODEL NO.	TYPE	INSERT SEAT	INSERT	INSERT SCREW	BORING AND PROCESSING AT FRONT					
					BORING RANGE	L	l ₁	l ₂	l ₃	d ₁
140.657.32.085	PSC32 x PMB32 - 85	SIC32 - 1	TB..06 TP..08	M2-5.0-2.7-60	32 ~ 42	104	85	55	25	16
140.657.32.085	PSC32 x PMB32 - 85	SIC32 - 2	TB..06 TP..08	M2-5.0-2.7-60	41 ~ 51	104	85	55	25	16
140.657.32.085	PSC32 x PMB32 - 85	SIC32 - 3	TB..06 TP..08	M2-5.0-2.7-60	50 ~ 60	104	85	55	25	16
141.657.41.102	PSC40 x PMB41 - 102	SIC41 - 1	TP..09 TC..11	M2.5-6.0-3.5-60	41 ~ 54	126	102	70	29	20
141.657.41.102	PSC40 x PMB41 - 102	SIC41 - 2	TP..09 TC..11	M2.5-6.0-3.5-60	50 ~ 63	126	102	70	29	20
141.657.41.102	PSC40 x PMB41 - 102	SIC41 - 3	TP..09 TC..11	M2.5-6.0-3.5-60	61 ~ 74	126	102	70	29	20
142.657.53.112	PSC50 x PMB53 - 112	SIC53 - 1	TP..09 TC..11	M2.5-6.0-3.5-60	53 ~ 70	142	112	74	34	25.5
142.657.53.112	PSC50 x PMB53 - 112	SIC53 - 2	TP..09 TC..11	M2.5-6.0-3.5-60	65 ~ 82	142	112	74	34	25.5
142.657.53.112	PSC50 x PMB53 - 112	SIC53 - 3	TP..09 TC..11	M2.5-6.0-3.5-60	78 ~ 95	142	112	74	34	25.5
143.657.68.140	PSC63 x PMB68 - 140	SIC68 - 1	TP..09 TC..11	M2.5-6.0-3.5-60	68 ~ 100	178	140	90.8	45.2	32.5
143.657.68.140	PSC63 x PMB68 - 140	SIC68 - 2	TP..09 TC..11	M2.5-6.0-3.5-60	94 ~ 126	178	140	90.8	45.2	32.5
143.657.68.140	PSC63 x PMB68 - 140	SIC68 - 3	TP..09 TC..11	M2.5-6.0-3.5-60	118 ~ 150	178	140	90.8	45.2	32.5

TYPES FOR INSERT SEAT:

TYPE	DRAWING	SUITABLE FINISH BORING HEAD	TYPE	DRAWING	SUITABLE FINISH BORING HEAD	STANDARD INSERT SEAT	OPTIONAL INSERT SEAT		
SIC32 - 1		PMB32	SIC32 - 1E		PMB32	SIC32 - 1	SIC32 - 2	SIC32 - 3	
SIC32 - 2			SIC32 - 2E			φ 32 ~ φ 42	φ 41 ~ φ 51	φ 50 ~ φ 60	
SIC32 - 3			SIC32 - 3E						
SIC41 - 1		PMB41	SIC41 - 1E		PMB41				
SIC41 - 2			SIC41 - 2E						
SIC41 - 3			SIC41 - 3E						
SIC53 - 1		PMB53	SIC53 - 1E		PMB53				
SIC53 - 2			SIC53 - 2E						
SIC53 - 3			SIC53 - 3E						
SIC68 - 1	PMB68	SIC68 - 1E	PMB68						
SIC68 - 2		SIC68 - 2E							
SIC68 - 3		SIC68 - 3E							

► For example: there are different boring ranges for different insert seats of PMB32.

Product information:

- Patent number: TW PAT NO. M340139 / TW PAT NO. M363355 / JP PAT NO. 3154595 / CN PAT NO. ZL200820102784.9 / DE PAT NO. Nr.202009009848.6 / US PAT NO. U8109699 B2 / TW PAT NO. M381470 / CN PAT NO. ZL200920139100.7 / ES PAT NO. 1072386.
- With the design of PSC one piece boring head to lock with adapters, the total length is shorter than old design and the rigidity and stability are improved!
- The body of PMB Finish Boring Head is always designed to have coolant outlet.
- There are 3 types of insert seats and the boring range of insert seat can be enlarged by exchanging another insert seat.
- SIC_-1 insert seat is a standard accessory. SIC_-2 and SIC_-3 insert seats are optional accessories and need to be purchased additionally.
- Inserts are optional accessories. Needs to be purchased additionally.

PSC / PCK ROUGH BORING HEAD

ONE-PIECE TYPE

PSC / PCK 可調整式雙刃粗搪孔頭[一體式]

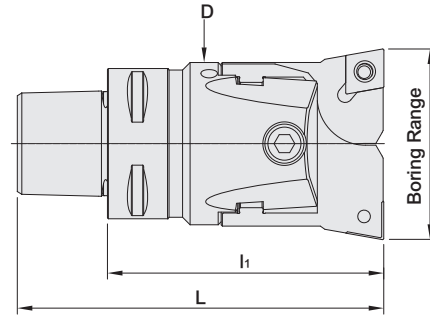

MODEL NO.	TYPE	BORING RANGE		L	l ₁	D	INSERT	SCREW	WRENCH	WEIGHT (KGS)
		MIN.	MAX.							
140.650.39.080	PSC32 x PCK3950 - 80	39	50	99	80	32	CC..09T3	M4 - 10 - 5.7 - 60	T15	0.49
141.650.49.082	PSC40 x PCK4965 - 82	49	65	106	82	42	CC..1204	M5 - 11 - 7.5 - 60	T20	0.49
142.650.63.092	PSC50 x PCK6382 - 92	63	82	122	92	54	CC..1204	M5 - 11 - 7.5 - 60	T20	0.70
143.650.80.140	PSC63 x PCK80102 - 140	80	102	178	140	68	CC..1204	M5 - 9.2 - 7.6 - 60	T20	3.60

Product information:

- ▶ With the design of PSC one piece boring head to lock with adapters, the total length is shorter than old design and the rigidity and stability are improved!
- ▶ Inserts are optional accessories. Needs to be purchased additionally.

PSC / PBJ FINISH BORING HEAD

ONE-PIECE TYPE

PSC / PBJ 高精密搪孔頭[一體式]

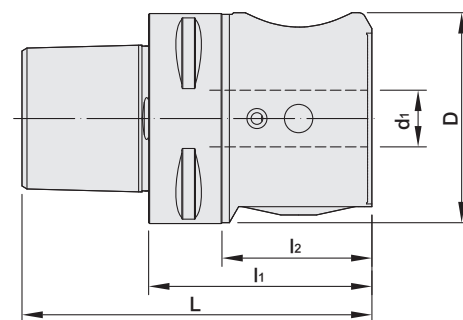

MODEL NO.	TYPE	L	l ₁	l ₂	D	d ₁	WEIGHT (KGS)
141.647.10.48.5	PSC40 x PBJ10 - 48.5	72.5	48.5	28.5	39	10	0.49
142.647.12.056	PSC50 x PBJ12 - 56	86	56	36	50	12	0.91
143.647.16.067	PSC63 x PBJ16 - 67	105	67	45	63.5	16	1.76

For adapters, please refer to

Adapter	Page	Adapter	Page
BT	▶ P.56	SCAT	▶ P.60
CAT	▶ P.57	SDAT	▶ P.61
DAT	▶ P.58	HSK	▶ P.62
SBT	▶ P.59		

Product information:

- ▶ Inserts are optional accessories. Needs to be purchased additionally.



MEMO

Blank memo area consisting of 18 horizontal grey lines for writing.



MCK BORING HEAD SHANK / HOLDER

BT / MCK BORING HEAD SHANK	P.32~36
CAT / MCK BORING HEAD SHANK	P.37
DAT / MCK BORING HEAD SHANK	P.38
SBT / MCK BORING HEAD SHANK	P.39~42
SCAT / MCK BORING HEAD SHANK	P.43
SDAT / MCK BORING HEAD SHANK	P.44
HSK / MCK BORING HEAD SHANK	P.45~46
PSC / MCK BORING HEAD SHANK	P.47~48

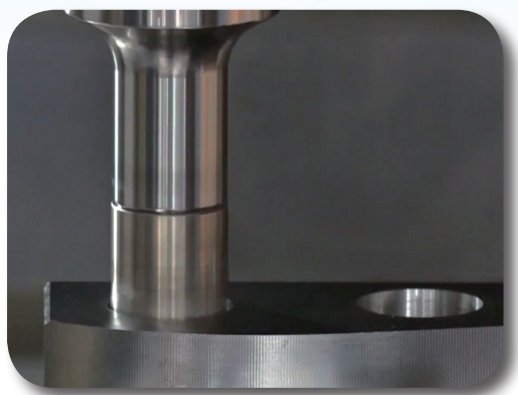

MCK CONNECTION SYSTEM

EXCELLENT CONTACT

- ▶ The 30° steep taper of set screw creates a radial and axial force after assembling, which results in excellent contact between boring head and shank.

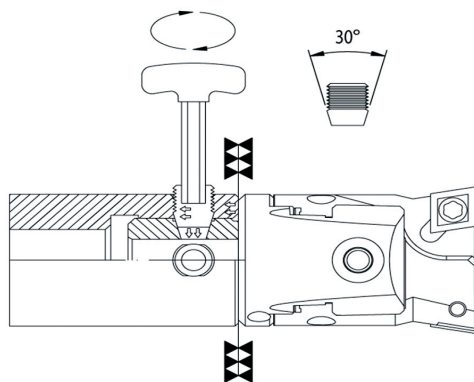

MCK CONNECTION

- ▶ Two set screws form 90° with the drive keys of spindle, ensuring the retract position during boring process.

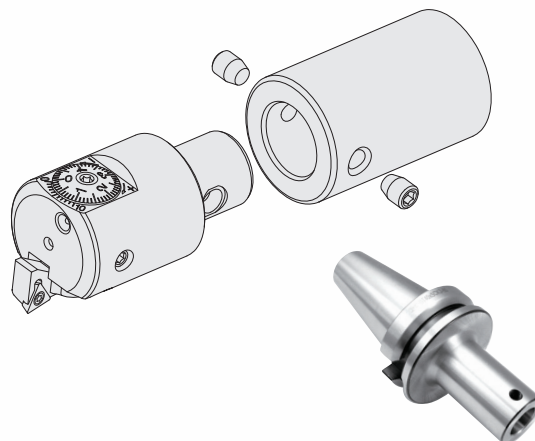

MODULAR DESIGN

- ▶ MCK connection system is a flexible modular system and able to increase the length with extension spacers and change boring diameters conveniently by changing different boring heads for long overhanging boring operations.

Extension spacer for same diameter



Extension spacer for different diameter



Better rigidity for anti-vibration

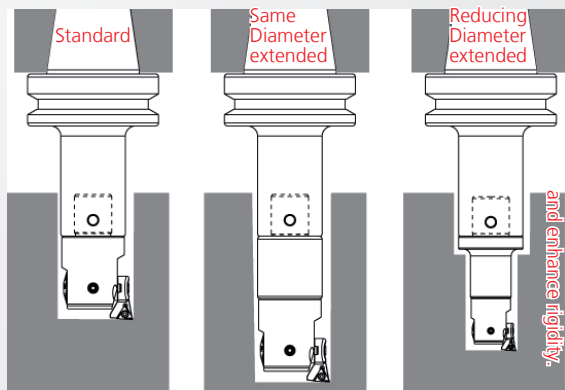

Can reduce interference and enhance rigidity.

BT / MCK BORING HEAD SHANK

BT / MCK 搪孔刀柄

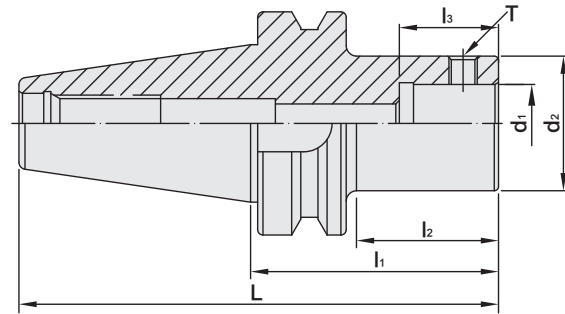

MODEL NO.	TYPE	L	l ₁	l ₂	l ₃	d ₁	d ₂	T	WEIGHT (KGS)
17530M	BT30 x MCK1 - 55	103.4	55	28	18	11	19	M4 x 0.5P	0.70
17530M - 70	BT30 x MCK1 - 70	118.4	70	43	18	11	19	M4 x 0.5P	0.80
17532M	BT30 x MCK2 - 60	108.4	60	33	18.5	14	23.5	M5 x 0.5P	0.80
17533M	BT30 x MCK2 - 75	123.4	75	48	18.5	14	23.5	M5 x 0.5P	0.80
17532M - 80	BT30 x MCK2 - 80	128.4	80	53	18.5	14	23.5	M5 x 0.5P	0.81
17534M	BT30 x MCK3 - 50	98.4	50	26	24	18	31	M6 x 0.75P	0.90
17534M - 80	BT30 x MCK3 - 80	128.4	80	56	24	18	31	M6 x 0.75P	0.95
17536M	BT30 x MCK4 - 60	108.4	60	37	28	22	39	M8 x 0.75P	1.00
17537M	BT30 x MCK4 - 70	118.4	70	47	29	22	39	M8 x 0.75P	1.00
17538M	BT30 x MCK5 - 70	118.4	70	47	35	28	50	M10 x 1.0P	1.10
17540M	BT30 x MCK6 - 60	108.4	60	38	42	36	63	M12 x 1.0P	1.20

Features:

- ▶ Internal tolerance is H6.
- ▶ Center though coolant supply is available.
- ▶ The pre-balance reaches G6.3 5,000 rpm. Higher balancing grade and revolution can be done upon request but additional charge is needed.
- ▶ MAS/BT30 tool holders are without coolant supply over collars.



BT / MCK BORING HEAD SHANK

BT / MCK 搪孔刀柄

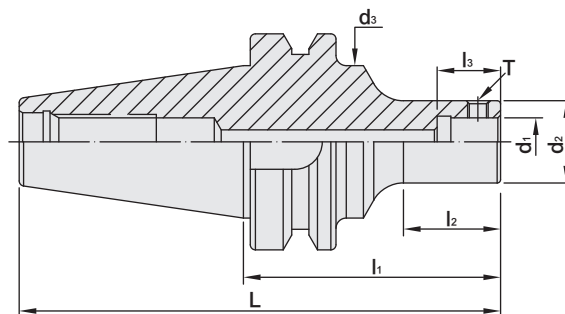

MODEL NO.	TYPE	L	l ₁	l ₂	l ₃	d ₁	d ₂	d ₃	T	WEIGHT (KGS)
17501M	BT40 x MCK1 - 100	165.4	100	51	18	11	19	44.45	M4 x 0.5P	1.20
17501M - 115	BT40 x MCK1 - 115	180.4	115	66	18	11	19	44.45	M4 x 0.5P	1.30
17502M	BT40 x MCK2 - 75	140.4	75	28	18.5	14	23.5	44.45	M5 x 0.5P	1.14
17502M - 85	BT40 x MCK2 - 85	150.4	85	38	18.5	14	23.5	44.45	M5 x 0.5P	1.24
17502M - 115	BT40 x MCK2 - 115	180.4	115	68	18.5	14	23.5	44.45	M5 x 0.5P	1.30
17502M - 175	BT40 x MCK2 - 175	240.4	175	128	18.5	14	23.5	44.45	M5 x 0.5P	1.40
17503M	BT40 x MCK3 - 80	145.4	80	48	24	18	31	-	M6 x 0.75P	3.90
17503M - 95	BT40 x MCK3 - 95	160.4	95	63	24	18	31	-	M6 x 0.75P	4.00
17503M - 125	BT40 x MCK3 - 125	190.4	125	93	24	18	31	-	M6 x 0.75P	4.10
17503M - 155	BT40 x MCK3 - 155	220.4	155	123	24	18	31	-	M6 x 0.75P	4.00
17503M - 200	BT40 x MCK3 - 200	265.4	200	168	24	18	31	-	M6 x 0.75P	4.10
17504M	BT40 x MCK4 - 70	135.4	70	40	28	22	39	-	M8 x 0.75P	4.20
17505M	BT40 x MCK4 - 100	165.4	100	70	28	22	39	-	M8 x 0.75P	4.40
17505M - 120	BT40 x MCK4 - 120	185.4	120	85	28	22	39	-	M8 x 0.75P	4.50
17505M - 130	BT40 x MCK4 - 130	195.4	130	98	28	22	39	-	M8 x 0.75P	1.66
17505M - 150	BT40 x MCK4 - 150	215.4	150	115	28	22	39	-	M8 x 0.75P	1.70
17505M - 175	BT40 x MCK4 - 175	240.4	175	143	28	22	39	-	M8 x 0.75P	1.76
17505M - 195	BT40 x MCK4 - 195	260.4	195	163	28	22	39	-	M8 x 0.75P	1.80

Features:

- ▶ Internal tolerance is H6.
- ▶ Center though coolant supply is available.
- ▶ The pre-balance reaches G6.3 5,000 rpm. Higher balancing grade and revolution can be done upon request but additional charge is needed.
- ▶ AD+B type is available, please inform us when making an order.

BT / MCK BORING HEAD SHANK

BT / MCK 搪孔刀柄

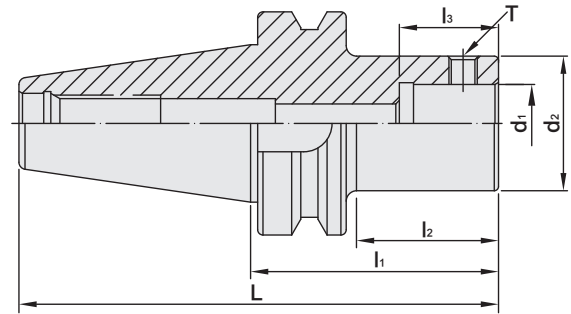

MODEL NO.	TYPE	L	l ₁	l ₂	l ₃	d ₁	d ₂	T	WEIGHT (KGS)
17506M	BT40 x MCK5 - 60	125.4	60	30	35	28	50	M10 x 1.0P	1.30
17507M	BT40 x MCK5 - 80	145.4	80	51	35	28	50	M10 x 1.0P	1.60
17507M - 100	BT40 x MCK5 - 100	165.4	100	70	35	28	50	M10 x 1.0P	1.65
17507M - 120	BT40 x MCK5 - 120	185.4	120	90	35	28	50	M10 x 1.0P	1.69
17507M - 125	BT40 x MCK5 - 125	190.4	125	96	35	28	50	M10 x 1.0P	1.70
17507M - 150	BT40 x MCK5 - 150	215.4	150	120	35	28	50	M10 x 1.0P	1.80
17507M - 175	BT40 x MCK5 - 175	240.4	175	146	35	28	50	M10 x 1.0P	1.90
17508M	BT40 x MCK6 - 55	120.4	55	28	42	36	63	M12 x 1.0P	2.15
17508M - 65	BT40 x MCK6 - 65	130.4	65	38	42	36	63	M12 x 1.0P	2.20
17508M - 100	BT40 x MCK6 - 100	165.4	100	73	42	36	63	M12 x 1.0P	2.30
17508M - 115	BT40 x MCK6 - 115	180.4	115	88	42	36	63	M12 x 1.0P	2.40
17508M - 120	BT40 x MCK6 - 120	185.4	120	93	42	36	63	M12 x 1.0P	2.41
17508M - 150	BT40 x MCK6 - 150	215.4	150	123	42	36	63	M12 x 1.0P	2.45
17508M - 165	BT40 x MCK6 - 165	230.4	165	138	42	36	63	M12 x 1.0P	2.50

Features:

- ▶ Internal tolerance is H6.
- ▶ Center through coolant supply is available.
- ▶ The pre-balance reaches G6.3 5,000 rpm. Higher balancing grade and revolution can be done upon request but additional charge is needed.



BT / MCK BORING HEAD SHANK

BT / MCK 搪孔刀柄

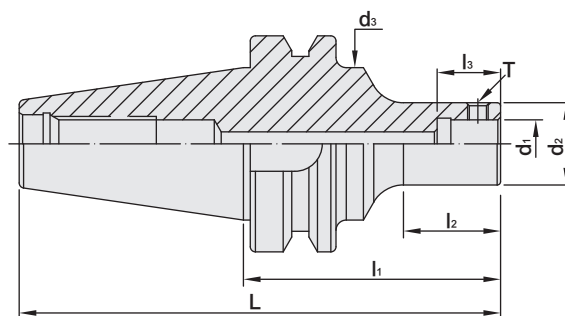

MODEL NO.	TYPE	L	l ₁	l ₂	l ₃	d ₁	d ₂	d ₃	T	WEIGHT (KGS)
17509M	BT50 x MCK1 - 105	206.8	105	38	18	11	19	69.85	M4 x 0.5P	3.90
17509M - 115	BT50 x MCK1 - 115	216.8	115	48	18	11	19	69.85	M4 x 0.5P	4.00
17509M - 145	BT50 x MCK1 - 145	246.8	145	78	18	11	19	69.85	M4 x 0.5P	4.10
17510M	BT50 x MCK2 - 105	206.8	105	39	18.5	14	23.5	69.85	M5 x 0.5P	4.00
17510M - 135	BT50 x MCK2 - 135	236.8	135	67	18.5	14	23.5	69.85	M5 x 0.5P	4.10
17510M - 140	BT50 x MCK2 - 140	241.8	140	74	18.5	14	23.5	69.85	M5 x 0.5P	4.20
17510M - 175	BT50 x MCK2 - 175	276.8	175	109	18.5	14	23.5	69.85	M5 x 0.5P	4.40
17510M - 225	BT50 x MCK2 - 225	326.8	225	159	18.5	14	23.5	69.85	M5 x 0.5P	4.50
17511M	BT50 x MCK3 - 110	211.8	110	62	24	18	31	-	M6 x 0.75P	4.40
17512M	BT50 x MCK3 - 140	241.8	140	92	24	18	31	-	M6 x 0.75P	4.60
17511M - 155	BT50 x MCK3 - 155	256.8	155	107	24	18	31	-	M6 x 0.75P	4.80
17511M - 200	BT50 x MCK3 - 200	301.8	200	152	24	18	31	-	M6 x 0.75P	5.00
17511M - 240	BT50 x MCK3 - 240	341.8	240	192	24	18	31	-	M6 x 0.75P	5.20
17513M	BT50 x MCK4 - 100	201.8	100	52	28	22	39	-	M8 x 0.75P	4.80
17514M	BT50 x MCK4 - 160	261.8	160	112	28	22	39	-	M8 x 0.75P	5.20
17514M - 175	BT50 x MCK4 - 175	276.8	175	127	28	22	39	-	M8 x 0.75P	2.30
17514M - 205	BT50 x MCK4 - 205	306.8	205	160	28	22	39	-	M8 x 0.75P	5.40
17514M - 235	BT50 x MCK4 - 235	336.8	235	187	28	22	39	-	M8 x 0.75P	5.50
17514M - 265	BT50 x MCK4 - 265	366.8	265	217	28	22	39	-	M8 x 0.75P	5.60

Features:

- ▶ Internal tolerance is H6.
- ▶ Center though coolant supply is available.
- ▶ The pre-balance reaches G6.3 5,000 rpm. Higher balancing grade and revolution can be done upon request but additional charge is needed.
- ▶ AD+B type is available, please inform us when making an order.

BT / MCK BORING HEAD SHANK

BT / MCK 搪孔刀柄

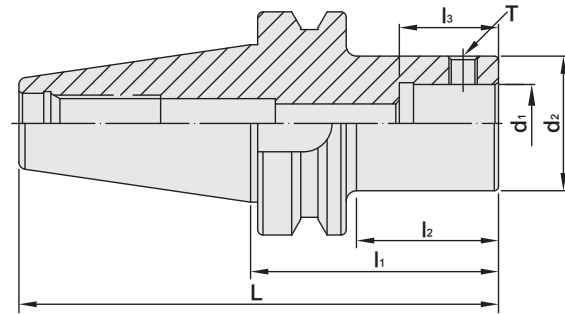

MODEL NO.	TYPE	L	l ₁	l ₂	l ₃	d ₁	d ₂	T	WEIGHT (KGS)
17515M	BT50 x MCK5 - 90	191.8	90	42	35	28	50	M10 x 1.0P	5.40
17515M - 105	BT50 x MCK5 - 105	206.8	105	57	35	28	50	M10 x 1.0P	5.60
17515M - 110	BT50 x MCK5 - 110	211.8	110	62	35	28	50	M10 x 1.0P	5.70
17516M	BT50 x MCK5 - 165	266.8	165	117	35	28	50	M10 x 1.0P	6.20
17516M - 185	BT50 x MCK5 - 185	286.8	185	137	35	28	50	M10 x 1.0P	6.30
17517M	BT50 x MCK5 - 210	311.8	210	162	35	28	50	M10 x 1.0P	6.40
17517M - 240	BT50 x MCK5 - 240	341.8	240	192	35	28	50	M10 x 1.0P	6.60
17517M - 265	BT50 x MCK5 - 265	366.8	265	217	35	28	50	M10 x 1.0P	6.70
17517M - 300	BT50 x MCK5 - 300	401.8	300	252	35	28	50	M10 x 1.0P	6.80
17518M	BT50 x MCK6 - 85	186.8	85	37	42	36	63	M12 x 1.0P	5.90
17519M	BT50 x MCK6 - 155	256.8	155	107	42	36	63	M12 x 1.0P	6.50
17520M	BT50 x MCK6 - 215	316.8	215	167	42	36	63	M12 x 1.0P	6.90
17520M - 240	BT50 x MCK6 - 240	341.8	240	192	42	36	63	M12 x 1.0P	6.95
17520M - 265	BT50 x MCK6 - 265	366.8	265	217	42	36	63	M12 x 1.0P	7.00
17520M - 290	BT50 x MCK6 - 290	391.8	290	242	42	36	63	M12 x 1.0P	7.10
17520M - 300	BT50 x MCK6 - 300	401.8	300	252	42	36	63	M12 x 1.0P	7.12
17520M - 350	BT50 x MCK6 - 350	451.8	350	302	42	36	63	M12 x 1.0P	7.50
17522M - 93	BT50 x MCK7 - 93	194.8	93	52	52	46	90	M20 x 1.5P	5.00
17522M - 183	BT50 x MCK7 - 183	284.8	183	142	52	46	90	M20 x 1.5P	9.40
17522M - 243	BT50 x MCK7 - 243	344.8	243	202	52	46	90	M20 x 1.5P	6.90

Features:

- ▶ Internal tolerance is H6.
- ▶ Center though coolant supply is available.
- ▶ The pre-balance reaches G6.3 5,000 rpm. Higher balancing grade and revolution can be done upon request but additional charge is needed.
- ▶ AD+B type is available, please inform us when making an order.



CAT / MCK BORING HEAD SHANK

CAT / MCK 搪孔刀柄

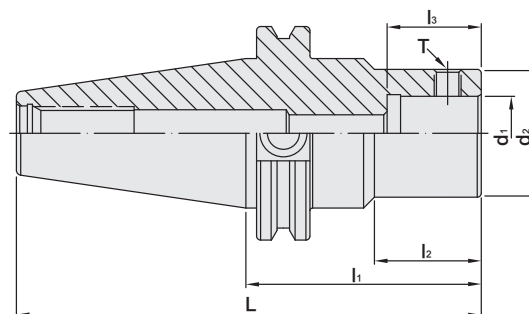

INCHES

MODEL NO.	TYPE	L	l ₁	l ₂	l ₃	d ₁	d ₂	T	WEIGHT (KGS)
27910M	CAT40 x MCK1 - 3"	5.687	3	1.105	0.708	0.433	0.748	M4 x 0.5P	1.20
27912M	CAT40 x MCK1 - 3.75"	6.437	3.75	1.856	0.708	0.433	0.748	M4 x 0.5P	1.25
27914M	CAT40 x MCK2 - 3"	5.687	3	1.39	0.728	0.551	0.925	M5 x 0.5P	1.30
27916M	CAT40 x MCK2 - 4.35"	7.037	4.35	2.656	0.728	0.551	0.925	M5 x 0.5P	1.35
27918M	CAT40 x MCK3 - 3"	5.687	3	1.356	0.945	0.709	1.22	M6 x 0.75P	1.40
27920M	CAT40 x MCK3 - 5"	7.687	5	3.36	0.945	0.709	1.22	M6 x 0.75P	1.45
27922M	CAT40 x MCK4 - 3"	5.687	3	1.515	1.102	0.866	1.535	M8 x 0.75P	1.50
27924M	CAT40 x MCK4 - 4.25"	6.937	4.25	2.765	1.102	0.866	1.535	M8 x 0.75P	1.55
27926M	CAT40 x MCK5 - 3"	5.687	3	2.219	1.378	1.102	1.969	M10 x 1.0P	1.60
27928M	CAT40 x MCK5 - 4.25"	6.937	4.25	3.469	1.378	1.102	1.969	M10 x 1.0P	1.65
27930M	CAT40 x MCK6 - 3"	5.687	3	2.219	1.653	1.417	2.48	M12 x 1.0P	1.70
27932M	CAT40 x MCK6 - 4.25"	6.937	4.25	3.469	1.653	1.417	2.48	M12 x 1.0P	1.75
27934M	CAT50 x MCK1 - 3.5"	7.5	3.5	1.317	0.708	0.433	0.748	M4 x 0.5P	3.30
27936M	CAT50 x MCK1 - 4"	8	4	1.817	0.708	0.433	0.748	M4 x 0.5P	3.35
27938M	CAT50 x MCK2 - 3.5"	7.5	3.5	1.368	0.728	0.551	0.925	M5 x 0.5P	3.40
27940M	CAT50 x MCK2 - 5.3"	9.3	5.3	3.167	0.728	0.551	0.925	M5 x 0.5P	3.45
27942M	CAT50 x MCK3 - 3.5"	7.5	3.5	1.453	0.945	0.709	1.22	M6 x 0.75P	3.50
27944M	CAT50 x MCK3 - 5.5"	9.5	5.5	3.453	0.945	0.709	1.22	M6 x 0.75P	3.55
27946M	CAT50 x MCK4 - 3.5"	7.5	3.5	1.544	1.102	0.866	1.535	M8 x 0.75P	3.60
27948M	CAT50 x MCK4 - 5.5"	9.5	5.5	3.544	1.102	0.866	1.535	M8 x 0.75P	3.65
27950M	CAT50 x MCK5 - 3.5"	7.5	3.5	1.669	1.378	1.102	1.969	M10 x 1.0P	3.70
27952M	CAT50 x MCK5 - 5.5"	9.5	5.5	3.669	1.378	1.102	1.969	M10 x 1.0P	3.75
27954M	CAT50 x MCK6 - 3.5"	7.5	3.5	1.988	1.653	1.417	2.48	M12 x 1.0P	3.80
27956M	CAT50 x MCK6 - 5.5"	9.5	5.5	3.987	1.653	1.417	2.48	M12 x 1.0P	3.85
27958M	CAT50 x MCK7-3.74"	7.74	3.74	2.362	2.047	1.811	3.54	M20 x 1.5P	5.00

Features:

- ▶ Internal tolerance is H6.
- ▶ Center through coolant supply is available.
- ▶ The pre-balance reaches G6.3 5,000 rpm. Higher balancing grade and revolution can be done upon request but additional charge is needed.
- ▶ AD+B type is available, please inform us when making an order.

DAT / MCK BORING HEAD SHANK

DAT / MCK 搪孔刀柄

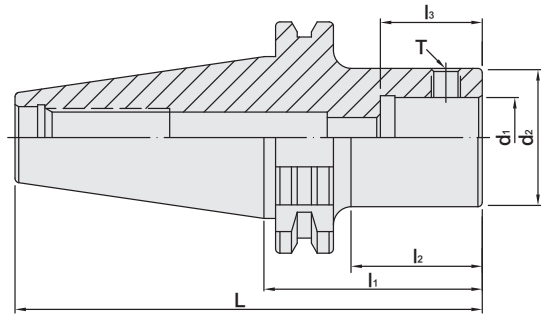

MODEL NO.	TYPE	L	l ₁	l ₂	l ₃	d ₁	d ₂	T	WEIGHT (KGS)
47502M	DAT30 x MCK1 - 50	97.8	50	27.9	18	11	19	M4 x 0.5P	0.60
47504M	DAT30 x MCK2 - 65	112.8	65	42.9	18.5	14	23.5	M5 x 0.5P	0.70
47506M	DAT30 x MCK3 - 50	97.8	50	27.9	24	18	31	M6 x 0.75P	0.80
47508M	DAT30 x MCK4 - 50	97.8	50	27.9	28	22	39	M8 x 0.75P	1.30
47510M	DAT40 x MCK1 - 80	148.4	80	50.9	18	11	19	M4 x 0.5P	1.00
47512M	DAT40 x MCK1 - 95	163.4	95	65.9	18	11	19	M4 x 0.5P	1.05
47514M	DAT40 x MCK2 - 80	148.4	80	50.9	18.5	14	23.5	M5 x 0.5P	1.10
47516M	DAT40 x MCK2 - 110	178.4	110	80.9	18.5	14	23.5	M5 x 0.5P	1.15
47518M	DAT40 x MCK3 - 90	158.4	90	65.9	24	18	31	M6 x 0.75P	1.20
47520M	DAT40 x MCK3 - 125	193.4	125	100.9	24	18	31	M6 x 0.75P	1.25
47522M	DAT40 x MCK4 - 80	148.4	80	55.9	28	22	39	M8 x 0.75P	1.30
47524M	DAT40 x MCK4 - 110	178.4	110	85.9	28	22	39	M8 x 0.75P	1.35
47526M	DAT40 x MCK5 - 95	163.4	95	75.4	35	28	50	M10 x 1.0P	1.40
47528M	DAT40 x MCK5 - 110	178.4	110	90.4	35	28	50	M10 x 1.0P	1.45
47530M	DAT40 x MCK6 - 65	133.4	65	45.4	42	36	63	M12 x 1.0P	1.50
47532M	DAT40 x MCK6 - 95	163.4	95	75.4	42	36	63	M12 x 1.0P	1.55
47534M	DAT50 x MCK1 - 110	211.75	110	80.9	18	11	19	M4 x 0.5P	3.10
47536M	DAT50 x MCK1 - 125	226.75	125	95.9	18	11	19	M4 x 0.5P	3.15
47538M	DAT50 x MCK2 - 95	196.75	95	65.9	18.5	14	23.5	M5 x 0.5P	3.20
47540M	DAT50 x MCK2 - 125	226.75	125	95.9	18.5	14	23.5	M5 x 0.5P	3.25
47542M	DAT50 x MCK3 - 125	226.75	125	95.9	24	18	31	M6 x 0.75P	3.30
47544M	DAT50 x MCK3 - 155	256.75	155	125.9	24	18	31	M6 x 0.75P	3.35
47546M	DAT50 x MCK4 - 110	211.75	110	80.9	28	22	39	M8 x 0.75P	3.40
47548M	DAT50 x MCK4 - 125	226.75	125	95.9	28	22	39	M8 x 0.75P	3.45
47550M	DAT50 x MCK5 - 65	166.75	65	35.9	35	28	50	M10 x 1.0P	3.50
47552M	DAT50 x MCK5 - 140	241.75	140	110.9	35	28	50	M10 x 1.0P	3.55
47554M	DAT50 x MCK6 - 140	241.75	140	110.9	42	36	63	M12 x 1.0P	3.60
47556M	DAT50 x MCK6 - 170	271.75	170	140.9	42	36	63	M12 x 1.0P	3.65
47558M	DAT50 x MCK7-95	196.75	95	60	52	46	90	M20 x 1.5P	5.00

Features:

- ▶ Internal tolerance is H6.
- ▶ Center though coolant supply is available.
- ▶ The pre-balance reaches G6.3 5,000 rpm. Higher balancing grade and revolution can be done upon request but additional charge is needed.
- ▶ AD+B type is available, please inform us when making an order.



SBT / MCK BORING HEAD SHANK

Dual
DRIVE+

SBT / MCK 法蘭加厚型搪孔刀柄

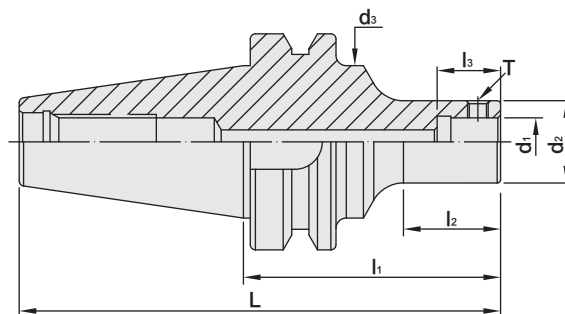

MODEL NO.	TYPE	L	l ₁	l ₂	l ₃	d ₁	d ₂	d ₃	T	WEIGHT (KGS)
26.487.01.100	SBT40 x MCK1 - 100	165.4	100	51	18	11	19	44.45	M4 x 0.5P	1.20
26.487.01.115	SBT40 x MCK1 - 115	180.4	115	66	18	11	19	44.45	M4 x 0.5P	1.30
26.487.02.075	SBT40 x MCK2 - 75	140.4	75	28	18.5	14	23.5	44.45	M5 x 0.5P	1.14
26.487.02.085	SBT40 x MCK2 - 85	150.4	85	38	18.5	14	23.5	44.45	M5 x 0.5P	1.20
26.487.02.115	SBT40 x MCK2 - 115	180.4	115	68	18.5	14	23.5	44.45	M5 x 0.5P	1.25
27.487.01.105	SBT50 x MCK1 - 105	206.8	105	38	18	11	19	69.85	M4 x 0.5P	3.90
27.487.01.115	SBT50 x MCK1 - 115	216.8	115	48	18	11	19	69.85	M4 x 0.5P	4.00
27.487.01.145	SBT50 x MCK1 - 145	246.8	145	97	18	11	19	69.85	M4 x 0.5P	4.10
27.487.02.105	SBT50 x MCK2 - 105	206.8	105	39	18.5	14	23.5	69.85	M5 x 0.5P	4.00
27.487.02.135	SBT50 x MCK2 - 135	236.8	135	67	18.5	14	23.5	69.85	M5 x 0.5P	4.10
27.487.02.140	SBT50 x MCK2 - 140	241.8	140	72	18.5	14	23.5	69.85	M5 x 0.5P	4.20

Features:

- ▶ Internal tolerance is H6.
- ▶ Center though coolant supply is available.
- ▶ The pre-balance reaches G6.3 5,000 rpm. Higher balancing grade and revolution can be done upon request but additional charge is needed.
- ▶ AD+B type is available, please inform us when making an order.

SBT / MCK BORING HEAD SHANK

Dual
DRIVE+

SBT / MCK 法蘭加厚型搪孔刀柄

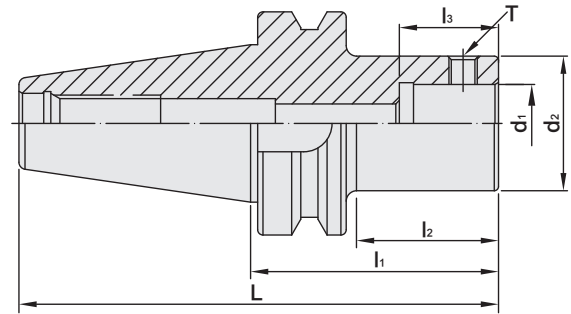

MODEL NO.	TYPE	L	l ₁	l ₂	l ₃	d ₁	d ₂	T	WEIGHT (KGS)
25.487.01.055	SBT30 x MCK1 - 55	103.4	55	28	18	11	19	M4 x 0.5P	0.70
25.487.01.070	SBT30 x MCK1 - 70	118.4	70	43	18	11	19	M4 x 0.5P	0.80
25.487.02.060	SBT30 x MCK2 - 60	108.4	60	33	18.5	14	23.5	M5 x 0.5P	0.80
25.487.02.075	SBT30 x MCK2 - 75	123.4	75	48	18.5	14	23.5	M5 x 0.5P	0.80
25.487.02.080	SBT30 x MCK2 - 80	128.4	80	53	18.5	14	23.5	M5 x 0.5P	0.85
25.487.03.050	SBT30 x MCK3 - 50	98.4	50	26	24	18	31	M6 x 0.75P	0.90
25.487.03.080	SBT30 x MCK3 - 80	128.4	80	56	24	18	31	M6 x 0.75P	0.95
25.487.04.060	SBT30 x MCK4 - 60	108.4	60	37	28	22	39	M8 x 0.75P	1.00
25.487.04.070	SBT30 x MCK4 - 70	118.4	70	47	28	22	39	M8 x 0.75P	1.00
25.487.05.070	SBT30 x MCK5 - 70	118.4	70	47	35	28	50	M10 x 1.0P	1.10
25.487.06.060	SBT30 x MCK6 - 60	108.4	60	38	42	36	63	M12 x 1.0P	1.20
26.487.03.080	SBT40 x MCK3 - 80	145.4	80	48	24	18	31	M6 x 0.75P	1.22
26.487.03.095	SBT40 x MCK3 - 95	160.4	95	63	24	18	31	M6 x 0.75P	1.24
26.487.03.125	SBT40 x MCK3 - 125	190.4	125	93	24	18	31	M6 x 0.75P	1.30
26.487.03.155	SBT40 x MCK3 - 155	220.4	155	123	24	18	31	M6 x 0.75P	1.40
26.487.04.070	SBT40 x MCK4 - 70	135.4	70	40	28	22	39	M8 x 0.75P	1.50
26.487.04.100	SBT40 x MCK4 - 100	165.4	100	70	28	22	39	M8 x 0.75P	1.56
26.487.04.130	SBT40 x MCK4 - 130	195.4	130	98	28	22	39	M8 x 0.75P	1.60
26.487.04.175	SBT40 x MCK4 - 175	240.4	175	143	28	22	39	M8 x 0.75P	1.70
26.487.05.060	SBT40 x MCK5 - 60	125.4	60	30	35	28	50	M10 x 1.0P	1.30
26.487.05.080	SBT40 x MCK5 - 80	145.4	80	51	35	28	50	M10 x 1.0P	1.60
26.487.05.125	SBT40 x MCK5 - 125	190.4	125	96	35	28	50	M10 x 1.0P	1.70
26.487.05.175	SBT40 x MCK5 - 175	240.4	175	146	35	28	50	M10 x 1.0P	1.80
26.487.06.055	SBT40 x MCK6 - 55	120.4	55	28	42	36	63	M12 x 1.0P	2.15
26.487.06.065	SBT40 x MCK6 - 65	130.4	65	38	42	36	63	M12 x 1.0P	2.20
26.487.06.115	SBT40 x MCK6 - 115	170.4	115	88	42	36	63	M12 x 1.0P	2.30
26.487.06.165	SBT40 x MCK6 - 165	230.4	165	138	42	36	63	M12 x 1.0P	2.50

Features:

- ▶ Internal tolerance is H6.
- ▶ Center through coolant supply is available.
- ▶ The pre-balance reaches G6.3 5,000 rpm. Higher balancing grade and revolution can be done upon request but additional charge is needed.
- ▶ AD+B type is available, please inform us when making an order.
- ▶ SBT30 tool holders are without coolant supply over collars.



SBT / MCK BORING HEAD SHANK

Dual
DRIVE+

SBT / MCK 法蘭加厚型搪孔刀柄

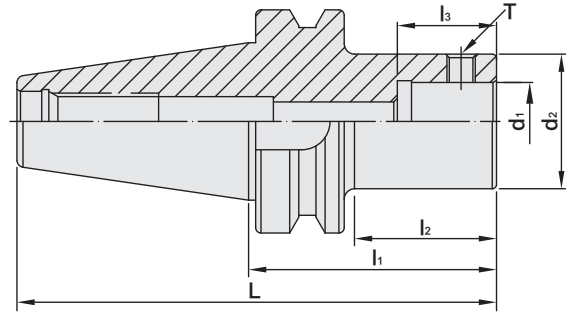

MODEL NO.	TYPE	L	l ₁	l ₂	l ₃	d ₁	d ₂	T	WEIGHT (KGS)
27.487.03.110	SBT50 x MCK3 - 110	211.8	110	62	24	18	31	M6 x 0.75P	4.40
27.487.03.140	SBT50 x MCK3 - 140	241.8	140	92	24	18	31	M6 x 0.75P	4.60
27.487.03.155	SBT50 x MCK3 - 155	256.8	155	107	24	18	31	M6 x 0.75P	4.80
27.487.04.100	SBT50 x MCK4 - 100	201.8	100	52	28	22	39	M8 x 0.75P	4.80
27.487.04.160	SBT50 x MCK4 - 160	261.8	160	112	28	22	39	M8 x 0.75P	5.20
27.487.04.175	SBT50 x MCK4 - 175	276.8	175	127	28	22	39	M8 x 0.75P	2.30
27.487.04.205	SBT50 x MCK4 - 205	306.8	205	205	28	22	39	M8 x 0.75P	5.40
27.487.05.090	SBT50 x MCK5 - 90	191.8	90	42	35	28	50	M10 x 1.0P	5.40
27.487.05.105	SBT50 x MCK5 - 105	206.8	105	57	35	28	50	M10 x 1.0P	5.60
27.487.05.165	SBT50 x MCK5 - 165	266.8	165	117	35	28	50	M10 x 1.0P	6.20
27.487.05.210	SBT50 x MCK5 - 210	311.8	210	162	35	28	50	M10 x 1.0P	6.40
27.487.05.240	SBT50 x MCK5 - 240	341.8	240	192	35	28	50	M10 x 1.0P	6.60
27.487.05.300	SBT50 x MCK5 - 300	401.8	300	252	35	28	50	M10 x 1.0P	6.80
27.487.06.085	SBT50 x MCK6 - 85	186.8	85	37	42	36	63	M12 x 1.0P	5.90
27.487.06.155	SBT50 x MCK6 - 155	256.8	155	107	42	36	63	M12 x 1.0P	6.50
27.487.06.215	SBT50 x MCK6 - 215	316.8	215	167	42	36	63	M12 x 1.0P	6.90

Features:

- ▶ Internal tolerance is H6.
- ▶ Center though coolant supply is available.
- ▶ The pre-balance reaches G6.3 5,000 rpm. Higher balancing grade and revolution can be done upon request but additional charge is needed.
- ▶ AD+B type is available, please inform us when making an order.

SBT / MCK BORING HEAD SHANK

Dual
DRIVE+

SBT / MCK 法蘭加厚型搪孔刀柄

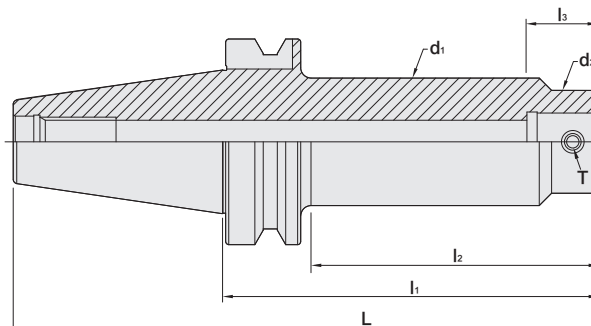

MODEL NO.	TYPE	L	l ₁	l ₂	l ₃	d ₁	d ₂	T	WEIGHT (KGS)
27.487.04.193	SBT50 x MCK4 - 193BG	294.8	193	150	28	48	39	M8 x 0.75P	5.50
27.487.04.238	SBT50 x MCK4 - 238BG	339.8	238	195	28	48	39	M8 x 0.75P	6.10
27.487.05.243	SBT50 x MCK5 - 243BG	344.8	243	200	35	62	50	M10 x 1.0P	8.10
27.487.05.303	SBT50 x MCK5 - 303BG	404.8	303	260	35	62	50	M10 x 1.0P	9.50
27.487.06.259	SBT50 x MCK6 - 259BG	360.8	259	216	42	72	63	M12 x 1.0P	10.3
27.487.06.314	SBT50 x MCK6 - 314BG	415.8	314	271	42	72	63	M12 x 1.0P	12.0
27.487.06.289	SBT50 x MCK6 - 289BG	390.8	289	246	42	80	63	M12 x 1.0P	12.9
27.487.06.349	SBT50 x MCK6 - 349BG	450.8	349	306	42	80	63	M12 x 1.0P	15.2

Features:

- ▶ Internal tolerance is H6.
- ▶ Center through coolant supply is available.
- ▶ The shank with the step design of outside diameter, improve the machining rigidity.
- ▶ The pre-balance reaches G6.3 5,000 rpm. Higher balancing grade and revolution can be done upon request but additional charge is needed.
- ▶ AD+B type is available, please inform us when making an order.



SCAT / MCK BORING HEAD SHANK

Dual
DRIVE+

SCAT / MCK 法蘭加厚型搪孔刀柄

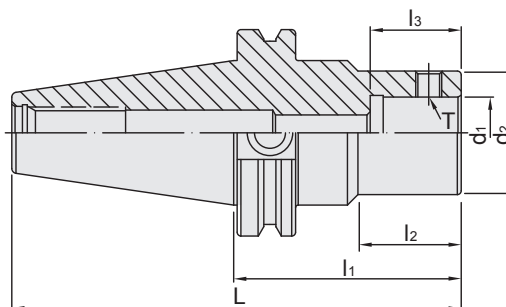

INCHES

MODEL NO.	TYPE	L	l ₁	l ₂	l ₃	d ₁	d ₂	T	WEIGHT (KGS)
43.487.01.300	SCAT40 x MCK1 - 3"	5.687	3	1.105	0.708	0.433	0.748	M4 x 0.5P	1.20
43.487.01.375	SCAT40 x MCK1 - 3.75"	6.437	3.75	1.856	0.708	0.433	0.748	M4 x 0.5P	1.25
43.487.02.300	SCAT40 x MCK2 - 3"	5.687	3	1.39	0.728	0.551	0.925	M5 x 0.5P	1.30
43.487.02.435	SCAT40 x MCK2 - 4.35"	7.037	4.35	2.656	0.728	0.551	0.925	M5 x 0.5P	1.35
43.487.03.300	SCAT40 x MCK3 - 3"	5.687	3	1.356	0.945	0.709	1.22	M6 x 0.75P	1.40
43.487.03.500	SCAT40 x MCK3 - 5"	7.687	5	3.36	0.945	0.709	1.22	M6 x 0.75P	1.45
43.487.04.300	SCAT40 x MCK4 - 3"	5.687	3	1.515	1.102	0.866	1.535	M8 x 0.75P	1.50
43.487.04.425	SCAT40 x MCK4 - 4.25"	6.937	4.25	2.765	1.102	0.866	1.535	M8 x 0.75P	1.55
43.487.05.300	SCAT40 x MCK5 - 3"	5.687	3	2.219	1.378	1.102	1.969	M10 x 1.0P	1.60
43.487.05.425	SCAT40 x MCK5 - 4.25"	6.937	4.25	3.469	1.378	1.102	1.969	M10 x 1.0P	1.65
43.487.06.300	SCAT40 x MCK6 - 3"	5.687	3	2.219	1.653	1.417	2.48	M12 x 1.0P	1.70
43.487.06.425	SCAT40 x MCK6 - 4.25"	6.937	4.25	3.469	1.653	1.417	2.48	M12 x 1.0P	1.75
44.487.01.350	SCAT50 x MCK1 - 3.5"	7.5	3.5	1.317	0.708	0.433	0.748	M4 x 0.5P	3.30
44.487.01.400	SCAT50 x MCK1 - 4"	8	4	1.817	0.708	0.433	0.748	M4 x 0.5P	3.35
44.487.02.350	SCAT50 x MCK2 - 3.5"	7.5	3.5	1.368	0.728	0.551	0.925	M5 x 0.5P	3.40
44.487.02.530	SCAT50 x MCK2 - 5.3"	9.3	5.3	3.167	0.728	0.551	0.925	M5 x 0.5P	3.45
44.487.03.350	SCAT50 x MCK3 - 3.5"	7.5	3.5	1.453	0.945	0.709	1.22	M6 x 0.75P	3.50
44.487.03.550	SCAT50 x MCK3 - 5.5"	9.5	5.5	3.453	0.945	0.709	1.22	M6 x 0.75P	3.55
44.487.04.350	SCAT50 x MCK4 - 3.5"	7.5	3.5	1.544	1.102	0.866	1.535	M8 x 0.75P	3.60
44.487.04.550	SCAT50 x MCK4 - 5.5"	9.5	5.5	3.544	1.102	0.866	1.535	M8 x 0.75P	3.65
44.487.05.350	SCAT50 x MCK5 - 3.5"	7.5	3.5	1.669	1.378	1.102	1.969	M10 x 1.0P	3.70
44.487.05.550	SCAT50 x MCK5 - 5.5"	9.5	5.5	3.669	1.378	1.102	1.969	M10 x 1.0P	3.75
44.487.06.350	SCAT50 x MCK6 - 3.5"	7.5	3.5	1.988	1.653	1.417	2.48	M12 x 1.0P	3.80
44.487.06.550	SCAT50 x MCK6 - 5.5"	9.5	5.5	3.987	1.653	1.417	2.48	M12 x 1.0P	3.85

Features:

- ▶ Internal tolerance is H6.
- ▶ Center though coolant supply is available.
- ▶ The pre-balance reaches G6.3 5,000 rpm. Higher balancing grade and revolution can be done upon request but additional charge is needed.
- ▶ AD+B type is available, please inform us when making an order.

SDAT / MCK BORING HEAD SHANK

Dual
DRIVE+

SDAT / MCK 法蘭加厚型搪孔刀柄

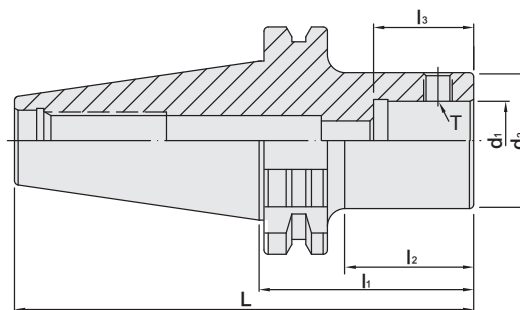

MODEL NO.	TYPE	L	l ₁	l ₂	l ₃	d ₁	d ₂	T	WEIGHT (KGS)
66.487.01.080	SDAT40 x MCK1 - 80	148.4	80	50.9	18	11	19	M4 x 0.5P	1.00
66.487.01.095	SDAT40 x MCK1 - 95	163.4	95	65.9	18	11	19	M4 x 0.5P	1.05
66.487.02.080	SDAT40 x MCK2 - 80	148.4	80	50.9	18.5	14	23.5	M5 x 0.5P	1.10
66.487.02.110	SDAT40 x MCK2 - 110	178.4	110	80.9	18.5	14	23.5	M5 x 0.5P	1.15
66.487.03.090	SDAT40 x MCK3 - 90	158.4	90	65.9	24	18	31	M6 x 0.75P	1.20
66.487.03.125	SDAT40 x MCK3 - 125	193.4	125	100.9	24	18	31	M6 x 0.75P	1.25
66.487.04.080	SDAT40 x MCK4 - 80	148.4	80	55.9	28	22	39	M8 x 0.75P	1.30
66.487.04.110	SDAT40 x MCK4 - 110	178.4	110	85.9	28	22	39	M8 x 0.75P	1.35
66.487.05.095	SDAT40 x MCK5 - 95	163.4	95	75.4	35	28	50	M10 x 1.0P	1.40
66.487.05.110	SDAT40 x MCK5 - 110	178.4	110	90.4	35	28	50	M10 x 1.0P	1.45
66.487.06.065	SDAT40 x MCK6 - 65	133.4	65	45.4	42	36	63	M12 x 1.0P	1.50
66.487.06.095	SDAT40 x MCK6 - 95	163.4	95	75.4	42	36	63	M12 x 1.0P	1.55
67.487.01.110	SDAT50 x MCK1 - 110	211.75	110	80.9	18	11	19	M4 x 0.5P	3.10
67.487.01.125	SDAT50 x MCK1 - 125	226.75	125	95.9	18	11	19	M4 x 0.5P	3.15
67.487.02.095	SDAT50 x MCK2 - 95	196.75	95	65.9	18.5	14	23.5	M5 x 0.5P	3.20
67.487.02.125	SDAT50 x MCK2 - 125	226.75	125	95.9	18.5	14	23.5	M5 x 0.5P	3.25
67.487.03.125	SDAT50 x MCK3 - 125	226.75	125	95.9	24	18	31	M6 x 0.75P	3.30
67.487.03.155	SDAT50 x MCK3 - 155	256.75	155	125.9	24	18	31	M6 x 0.75P	3.35
67.487.04.110	SDAT50 x MCK4 - 110	211.75	110	80.9	28	22	39	M8 x 0.75P	3.40
67.487.04.125	SDAT50 x MCK4 - 125	226.75	125	95.9	28	22	39	M8 x 0.75P	3.45
67.487.05.065	SDAT50 x MCK5 - 65	166.75	65	35.9	35	28	50	M10 x 1.0P	3.50
67.487.05.140	SDAT50 x MCK5 - 140	241.75	140	110.9	35	28	50	M10 x 1.0P	3.55
67.487.06.140	SDAT50 x MCK6 - 140	241.75	140	110.9	42	36	63	M12 x 1.0P	3.60
67.487.06.170	SDAT50 x MCK6 - 170	271.75	170	140.9	42	36	63	M12 x 1.0P	3.65

Features:

- ▶ Internal tolerance is H6.
- ▶ Center though coolant supply is available.
- ▶ The pre-balance reaches G6.3 5,000 rpm. Higher balancing grade and revolution can be done upon request but additional charge is needed.
- ▶ AD+B type is available, please inform us when making an order.



HSK / MCK BORING HEAD SHANK

HSK / MCK 搪孔刀柄

(DIN 69893-1)

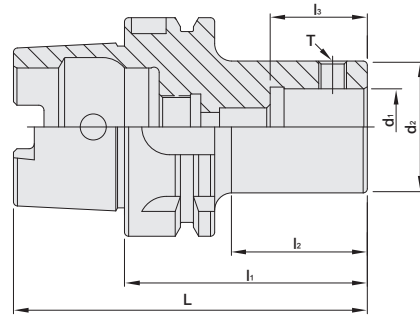

MODEL NO.	TYPE	L	l ₁	l ₂	l ₃	d ₁	d ₂	T	WEIGHT (KGS)
37620M	HSK40A x MCK1 - 50	70	50	27	18	11	19	M4 x 0.5P	0.60
37622M	HSK40A x MCK2 - 60	80	60	37	18.5	14	23.5	M5 x 0.5P	0.70
37624M	HSK40A x MCK3 - 60	80	60	38	24	18	31	M6 x 0.75P	0.80
37630M	HSK50A x MCK1 - 60	85	60	31	18	11	19	M4 x 0.5P	1.00
37632M	HSK50A x MCK2 - 60	85	60	31	18.5	14	23.5	M5 x 0.5P	1.10
37634M	HSK50A x MCK3 - 60	85	60	32	24	18	31	M6 x 0.75P	1.20
37636M	HSK50A x MCK4 - 60	85	60	32	28	22	39	M8 x 0.75P	1.30
37638M	HSK50A x MCK5 - 80	105	80	53	35	28	50	M10 x 1.0P	1.40
37640M	HSK50A x MCK6 - 80	105	80	53	42	36	63	M12 x 1.0P	1.50
37642M	HSK63A x MCK1 - 80	112	80	49	18	11	19	M4 x 0.5P	1.20
37644M	HSK63A x MCK1 - 95	127	95	64	18	11	19	M4 x 0.5P	1.25
37646M	HSK63A x MCK2 - 80	112	80	44	18.5	14	23.5	M5 x 0.5P	1.30
37648M	HSK63A x MCK2 - 110	142	110	79	18.5	14	23.5	M5 x 0.5P	1.35
37650M	HSK63A x MCK3 - 90	122	90	59	24	18	31	M6 x 0.75P	1.40
37652M	HSK63A x MCK3 - 125	157	125	94	24	18	31	M6 x 0.75P	1.45
37654M	HSK63A x MCK4 - 80	112	80	49	28	22	39	M8 x 0.75P	1.50
37656M	HSK63A x MCK4 - 110	142	110	79	28	22	39	M8 x 0.75P	1.55
37658M	HSK63A x MCK5 - 95	127	95	67.5	35	28	50	M10 x 1.0P	1.60
37660M	HSK63A x MCK5 - 110	142	110	82.5	35	28	50	M10 x 1.0P	1.65
37662M	HSK63A x MCK6 - 70	102	70	43.5	42	36	63	M12 x 1.0P	1.70
37664M	HSK63A x MCK6 - 95	127	95	68.5	42	36	63	M12 x 1.0P	1.75

Features:

- ▶ Internal tolerance is H6.
- ▶ Center though coolant supply is available

HSK / MCK BORING HEAD SHANK

HSK / MCK 搪孔刀柄

(DIN 69893-1)

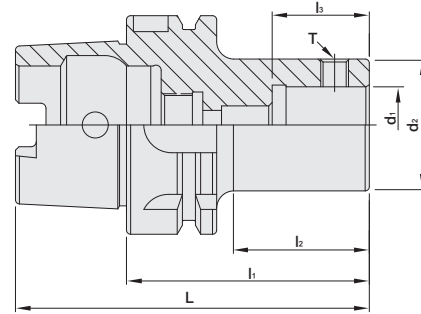

MODEL NO.	TYPE	L	l ₁	l ₂	l ₃	d ₁	d ₂	T	WEIGHT (KGS)
37686M - 100	HSK100A x MCK1 - 100	150	100	61	18	11	19	M4 x 0.5P	2.07
37688M	HSK100A x MCK2 - 75	125	75	36	18.5	14	23.5	M5 x 0.5P	2.09
37688M - 115	HSK100A x MCK2 - 115	165	115	76	18.5	14	23.5	M5 x 0.5P	2.18
37690M	HSK100A x MCK3 - 60	110	60	21	24	18	31	M6 x 0.75P	2.15
37690M - 125	HSK100A x MCK3 - 125	175	15	86	24	18	31	M6 x 0.75P	2.47
37692M	HSK100A x MCK4 - 70	120	70	31	28	22	39	M8 x 0.75P	2.34
37692M - 120	HSK100A x MCK4 - 120	170	120	86	28	22	39	M8 x 0.75P	2.76
37694M	HSK100A x MCK5 - 70	120	70	31	35	28	50	M10 x 1.0P	2.60
37694M - 110	HSK100A x MCK5 - 110	160	110	76	35	28	50	M10 x 1.0P	3.17
37696M	HSK100A x MCK6 - 75	125	75	41	42	36	63	M12 x 1.0P	3.02
37696M - 100	HSK100A x MCK6 - 100	150	100	66	42	36	63	M12 x 1.0P	3.60
37698M	HSK100A x MCK7-123	173	123	93	52	46	90	M20 x 1.5P	4.00
37698M-273	HSK100A x MCK7-273	323	273	228	52	46	90	M20 x 1.5P	5.00
37610M	HSK125A x MCK6 - 94	157	94	50	42	36	63	M12 x 1.0P	4.70
37612M	HSK125A x MCK7 - 123	186	123	84	52	46	90	M20 x 1.5P	7.20

Features:

- ▶ Internal tolerance is H6.
- ▶ Center through coolant supply is available.
- ▶ The pre-balance reaches G6.3 5,000 rpm. Higher balancing grade and revolution can be done upon request but additional charge is needed.



PSC / MCK BORING HEAD SHANK

PSC / MCK 搪頭刀柄

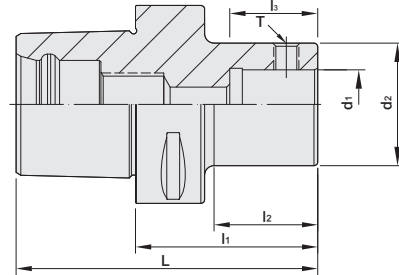

MODEL NO.	TYPE	L	l ₁	l ₂	l ₃	d ₁	d ₂	T	WEIGHT (KGS)
141.487.01.048	PSC40 x MCK1 - 48	72	48	22.5	18	11	19	M4 x 0.5P	0.40
141.487.02.045	PSC40 x MCK2 - 45	69	45	19.5	18.5	14	24	M5 x 0.5P	0.40
141.487.03.040	PSC40 x MCK3 - 40	64	40	17	24	18	31	M6 x 0.75P	0.50
141.487.04.033	PSC40 x MCK4 - 33	57	33	12.5	28	22	39	M8 x 0.75P	0.50
142.487.01.073	PSC50 x MCK1 - 73	103	73	47.5	18	11	19	M4 x 0.5P	0.50
142.487.02.085	PSC50 x MCK2 - 85	115	85	60.5	18.5	14	24	M5 x 0.5P	0.60
142.487.03.055	PSC50 x MCK3 - 55	85	55	30	24	18	31	M6 x 0.75P	0.60
142.487.03.080	PSC50 x MCK3 - 80	110	80	55	24	18	31	M6 x 0.75P	0.70
142.487.04.048	PSC50 x MCK4 - 48	78	48	23	28	22	39	M8 x 0.75P	0.60
142.487.04.073	PSC50 x MCK4 - 73	103	73	48	28	22	39	M8 x 0.75P	0.70
142.487.05.050	PSC50 x MCK5 - 50	80	50	30	35	28	50	M10 x 1.0P	0.60
142.487.05.083	PSC50 x MCK5 - 83	113	83	63	35	28	50	M10 x 1.0P	1.30
142.487.06.050	PSC50 x MCK6 - 50	80	50	30	42	36	63	M12 x 1.0P	1.00
143.487.01.078	PSC63 x MCK1 - 78	116	78	44	18	11	19	M4 x 0.5P	1.20
143.487.02.090	PSC63 x MCK2 - 90	128	90	53	18.5	14	24	M5 x 0.5P	1.30
143.487.03.065	PSC63 x MCK3 - 65	103	65	38	24	18	31	M6 x 0.75P	1.30
143.487.03.100	PSC63 x MCK3 - 100	138	100	73	24	18	31	M6 x 0.75P	1.50
143.487.04.058	PSC63 x MCK4 - 58	96	58	31	28	22	39	M8 x 0.75P	1.30
143.487.04.093	PSC63 x MCK4 - 93	131	93	66	28	22	39	M8 x 0.75P	1.70
143.487.05.048	PSC63 x MCK5 - 48	86	48	22	35	28	50	M10 x 1.0P	1.30
143.487.05.083	PSC63 x MCK5 - 83	121	83	57	35	28	50	M10 x 1.0P	1.70
143.487.06.059	PSC63 x MCK6 - 59	97	59	37	42	36	63	M12 x 1.0P	1.60
143.487.06.094	PSC63 x MCK6 - 94	132	94	72	42	36	63	M12 x 1.0P	2.30

Features:

- ▶ Internal tolerance is H6.
- ▶ Center though coolant supply is available.



PSC / MCK BORING HEAD SHANK

PSC / MCK 搪頭刀柄

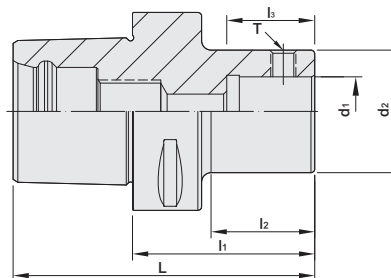

MODEL NO.	TYPE	L	l ₁	l ₂	l ₃	d ₁	d ₂	T	WEIGHT (KGS)
144.487.01.103	PSC80 x MCK1 - 103	151	103	68	18	11	19	M4 x 0.5P	2.60
144.487.02.115	PSC80 x MCK2 - 115	163	115	80	18.5	14	23.5	M5 x 0.5P	2.70
144.487.03.125	PSC80 x MCK3 - 125	173	125	90	24	18	31	M6 x 0.75P	2.90
144.487.04.118	PSC80 x MCK4 - 118	166	118	83	28	22	39	M8 x 0.75P	3.10
144.487.04.178	PSC80 x MCK4 - 178	226	178	138	28	22	39	M8 x 0.75P	3.70
144.487.05.108	PSC80 x MCK5 - 108	156	108	73	35	28	50	M10 x 1.0P	3.50
144.487.05.183	PSC80 x MCK5 - 183	231	183	143	35	28	50	M10 x 1.0P	4.60
144.487.06.074	PSC80 x MCK6 - 74	122	74	39	42	36	63	M12 x 1.0P	3.20
144.487.06.169	PSC80 x MCK6 - 169	217	169	134	42	36	63	M12 x 1.0P	5.80
144.487.07.073	PSC80 x MCK7 - 73	121	73	38	52	46	90	M20 x 1.5P	5.00
144.487.07.123	PSC80 x MCK7 - 123	171	123	88	52	46	90	M20 x 1.5P	8.40

Features:

- ▶ Internal tolerance is H6.
- ▶ Center though coolant supply is available.



MEMO

Blank memo area consisting of 18 horizontal grey lines for writing.



MCK ACCESSORIES

MCK EXTENSION SPACER

P.51

SIMPLIFIED TOOL PRESETTER FOR SRW & SMB BORING HEAD

P.52

MCK EXTENSION SPACER

MCK 搪孔頭延長桿

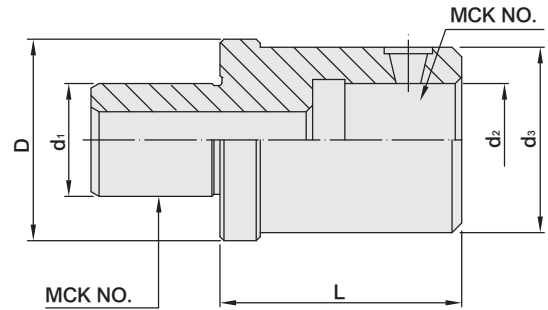

MODEL NO.	TYPE	L	D	d ₁	d ₂	d ₃	WEIGHT (KGS)
17550M	MCK1 - 1 - 30	30	-	11	11	19	0.20
17552M	MCK2 - 2 - 30	30	-	14	14	24	0.30
17554M	MCK3 - 2 - 37	37	31	18	14	24	0.34
17556M	MCK3 - 3 - 30	30	-	18	18	31	0.32
17558M	MCK4 - 2 - 50	50	39	22	14	24	0.60
17560M	MCK4 - 3 - 50	50	39	22	18	31	0.56
17562M	MCK4 - 4 - 45	45	-	22	22	39	0.52
17564M	MCK5 - 2 - 54	54	49	28	14	24	0.72
17566M	MCK5 - 3 - 47	47	49	28	18	31	0.70
17568M	MCK5 - 4 - 42	42	49	28	22	39	0.65
17570M	MCK5 - 5 - 60	60	-	28	28	50	0.60
17572M	MCK6 - 2 - 63	63	64	36	14	24	1.50
17574M	MCK6 - 3 - 56	56	64	36	18	31	1.30
17576M	MCK6 - 4 - 51	51	64	36	22	39	1.10
17578M	MCK6 - 5 - 41	41	64	36	28	50	1.05
17580M	MCK6 - 6 - 60	60	-	36	36	63	0.95

MODULAR DESIGN

- Mck connection system is a flexible modular system and able to increase the length with extension spacers and change boring diameters conveniently by changing different boring heads for long overhanging boring operations.

Extension spacer for same diameter



Extension spacer for different diameter



• Better rigidity for anti-vibration

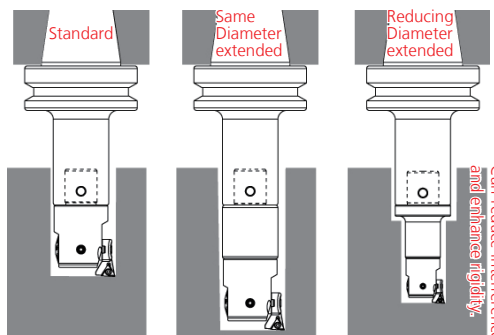

SIMPLIFIED TOOL PRESETTER FOR SRW & SMB BORING HEAD

簡易式搪刀設定儀

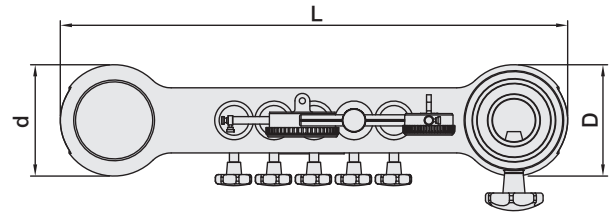

MODEL NO.	TYPE	L	D	d	MEASURING RANGE	MCK NO.	WEIGHT (KGS)
410.550	SET 410-550	410	55	55	$\phi 100 \sim \phi 550$	MCK7	10.4
410.830	SET 410-830	610	55	55	$\phi 550 \sim \phi 830$	MCK7	12.8

Features:

- ▶ Easy operation.
- ▶ Quick dimension adjustment.
- ▶ Specially used for SRW & SMB boring heads for boring dia. over 150mm. (Measuring range: $\phi 100\text{mm} \sim \phi 830\text{mm}$)
- ▶ Each unit of dial indicator: Radial: 0.02mm / Axial: 0.01mm.



MEMO

Blank memo area consisting of 18 horizontal grey lines for writing.



PSC ADAPTERS

BT / PSC ADAPTER	P.56
CAT / PSC ADAPTER	P.57
DAT / PSC ADAPTER	P.58
SBT / PSC ADAPTER	P.59
SCAT / PSC ADAPTER	P.60
SDAT / PSC ADAPTER	P.61
HSK / PSC ADAPTER	P.62
PSC / EXTENSION ADAPTER FOR SAME DIAMETER	P.63
PSC / EXTENSION ADAPTER FOR DIFFERENT DIAMETER	P.64

APPLICATION DIAGRAM



PSC Adapter

For adapters, please refer to

Adapter	Page
BT / PSC	P.56
CAT / PSC	P.57
DAT / PSC	P.58
SBT / PSC	P.59
SCAT / PSC	P.60
SDAT / PSC	P.61
HSK / PSC	P.62



PSC Extension Adapter for Same Diameter

P.63



PSC Extension Adapter for Different Diameter

P.64



PSC / PMB Finish Boring Head

P.27



PSC / PCK Rough Boring Head

P.28



PSC / PBJ Finish Boring Head

P.28



PSC / SPMB Damping Finish Boring Head

P.04

BT / PSC ADAPTER

BT / PSC 套筒

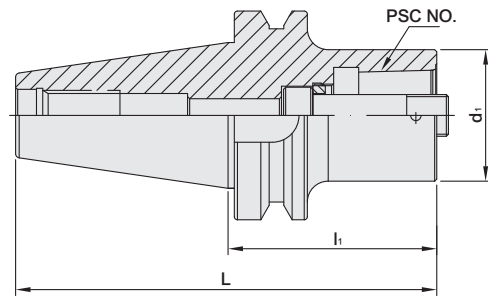

MODEL NO.	TYPE	NO.	L	l ₁	d ₁	TORQUE		WEIGHT (KGS)
						MIN.	MAX.	
12.501.32.040	BT50 x PSC32 - 40	PSC32	141.8	40	32	45 Nm	55 Nm	4.60
12.501.40.040	BT50 x PSC40 - 40	PSC40	141.8	40	40	45 Nm	55 Nm	4.60
12.501.50.040	BT50 x PSC50 - 40	PSC50	141.8	40	50	45 Nm	55 Nm	4.60
12.501.63.100	BT50 x PSC63 - 100	PSC63	201.8	100	63	65 Nm	75 Nm	5.00
12.501.63.150	BT50 x PSC63 - 150	PSC63	251.8	150	63	65 Nm	75 Nm	5.93
12.501.63.200	BT50 x PSC63 - 200	PSC63	301.8	200	63	65 Nm	75 Nm	6.99
12.501.63.250	BT50 x PSC63 - 250	PSC63	351.8	250	63	65 Nm	75 Nm	8.06
12.501.63.300	BT50 x PSC63 - 300	PSC63	401.8	300	63	65 Nm	75 Nm	8.91
12.501.80.070	BT50 x PSC80 - 70	PSC80	171.8	70	80	65 Nm	75 Nm	3.86
12.501.80.120	BT50 x PSC80 - 120	PSC80	221.8	120	80	65 Nm	75 Nm	5.67

CAT / PSC ADAPTER

CAT / PSC 套筒

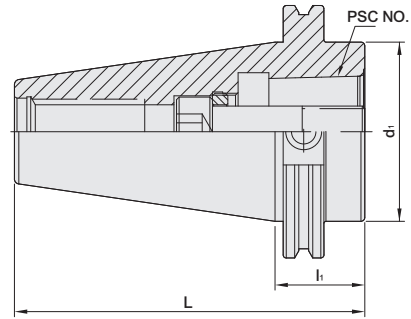

MODEL NO.	TYPE	NO.	L	l ₁	d ₁	T	TORQUE		WEIGHT (KGS)
							MIN.	MAX.	
31.501.32.035	CAT40 x PSC32 - 35	PSC32	103.249	35	44.45	M12 x 1.5P	45 Nm	55 Nm	0.99
31.501.40.035	CAT40 x PSC40 - 35	PSC40	103.249	35	44.45	M14 x 1.5P	45 Nm	55 Nm	0.90
31.501.50.035	CAT40 x PSC50 - 35	PSC50	103.249	35	44.45	M16 x 1.5P	45 Nm	55 Nm	0.82
31.501.63.090	CAT40 x PSC63 - 90	PSC63	158.249	90	44.45	M20 x 2.0P	65 Nm	75 Nm	1.83
32.501.32.035	CAT50 x PSC32 - 35	PSC32	136.6	35	69.85	M12 x 1.5P	45 Nm	55 Nm	3.00
32.501.40.035	CAT50 x PSC40 - 35	PSC40	136.6	35	69.85	M14 x 1.5P	45 Nm	55 Nm	2.95
32.501.50.035	CAT50 x PSC50 - 35	PSC50	136.6	35	69.85	M16 x 1.5P	45 Nm	55 Nm	2.85
32.501.63.035	CAT50 x PSC63 - 35	PSC63	136.6	35	69.85	M20 x 2.0P	65 Nm	75 Nm	2.63

INCHES

32.501.63.400	CAT50 x PSC63 - 4"	PSC63	184.15	101.6	69.85	M20 x 2.0P	65 Nm	75 Nm	4.05
32.501.63.600	CAT50 x PSC63 - 6"	PSC63	234.95	152.4	69.85	M20 x 2.0P	65 Nm	75 Nm	5.14
32.501.63.800	CAT50 x PSC63 - 8"	PSC63	285.75	203.2	69.85	M20 x 2.0P	65 Nm	75 Nm	6.23
32.501.63.100	CAT50 x PSC63 - 10"	PSC63	336.55	254	69.85	M20 x 2.0P	65 Nm	75 Nm	7.31
32.501.63.120	CAT50 x PSC63 - 12"	PSC63	387.35	304.8	69.85	M20 x 2.0P	65 Nm	75 Nm	8.40
32.501.80.374	CAT50 x PSC80 - 3.74"	PSC80	196.596	94.996	80.01	M20 x 2.0P	65 Nm	75 Nm	3.05

DAT / PSC ADAPTER

DAT / PSC 套筒

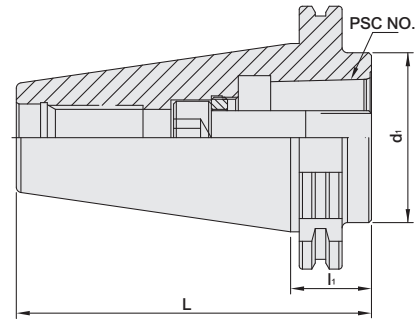

MODEL NO.	TYPE	NO.	L	l ₁	d ₁	TORQUE		WEIGHT (KGS)
						MIN.	MAX.	
52.501.32.030	DAT50 x PSC32 - 30	PSC32	131.75	30	32	45 Nm	55 Nm	4.20
52.501.40.030	DAT50 x PSC40 - 30	PSC40	131.75	30	40	45 Nm	55 Nm	4.30
52.501.50.030	DAT50 x PSC50 - 30	PSC50	131.75	30	50	45 Nm	55 Nm	4.40
52.501.63.030	DAT50 x PSC63 - 30	PSC63	131.75	30	63	65 Nm	75 Nm	4.50
52.501.63.100	DAT50 x PSC63 - 100	PSC63	201.75	100	63	65 Nm	75 Nm	5.00
52.501.63.150	DAT50 x PSC63 - 150	PSC63	251.75	150	63	65 Nm	75 Nm	5.20
52.501.63.200	DAT50 x PSC63 - 200	PSC63	301.75	200	63	65 Nm	75 Nm	5.40
52.501.63.250	DAT50 x PSC63 - 250	PSC63	351.75	250	63	65 Nm	75 Nm	5.80
52.501.63.300	DAT50 x PSC63 - 300	PSC63	401.75	300	63	65 Nm	75 Nm	6.00
52.501.80.050	DAT50 x PSC80 - 50	PSC80	151.75	50	80	65 Nm	75 Nm	4.80
52.501.80.070	DAT50 x PSC80 - 70	PSC80	171.75	70	80	65 Nm	75 Nm	4.90
52.501.80.100	DAT50 x PSC80 - 100	PSC80	201.75	100	80	65 Nm	75 Nm	5.10
52.501.80.120	DAT50 x PSC80 - 120	PSC80	221.75	120	80	65 Nm	75 Nm	5.20

SBT / PSC ADAPTER

Dual
DRIVE+

SBT / PSC 法蘭加厚型套筒

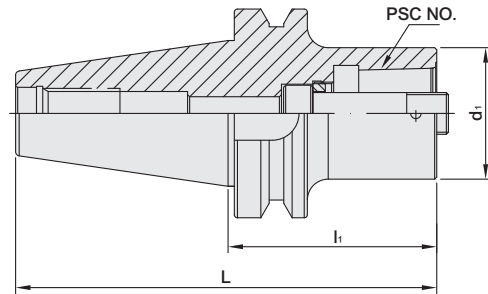

MODEL NO.	TYPE	NO.	L	l ₁	d ₁	T	TORQUE		WEIGHT (KGS)
							MIN.	MAX.	
26.501.32.030	SBT40 x PSC32 - 30	PSC32	95.4	30	32	M12 x 1.5P	45 Nm	55 Nm	1.70
26.501.40.030	SBT40 x PSC40 - 30	PSC40	95.4	30	40	M14 x 1.5P	45 Nm	55 Nm	1.70
26.501.50.030	SBT40 x PSC50 - 30	PSC50	95.4	30	50	M16 x 1.5P	45 Nm	55 Nm	1.70
26.501.63.075	SBT40 x PSC63 - 75	PSC63	140.4	75	63	M20 x 2.0P	65 Nm	75 Nm	1.90
26.501.80.135	SBT40 x PSC80 - 135	PSC80	200.4	135	80	M20 x 2.0P	65 Nm	75 Nm	3.78
27.501.32.040	SBT50 x PSC32 - 40	PSC32	141.8	40	32	M12 x 1.5P	45 Nm	55 Nm	4.80
27.501.40.040	SBT50 x PSC40 - 40	PSC40	141.8	40	40	M14 x 1.5P	45 Nm	55 Nm	4.80
27.501.50.040	SBT50 x PSC50 - 40	PSC50	141.8	40	50	M16 x 1.5P	45 Nm	55 Nm	4.80
27.501.63.100	SBT50 x PSC63 - 100	PSC63	201.8	100	63	M20 x 2.0P	65 Nm	75 Nm	4.68
27.501.63.150	SBT50 x PSC63 - 150	PSC63	251.8	150	63	M20 x 2.0P	65 Nm	75 Nm	5.75
27.501.63.200	SBT50 x PSC63 - 200	PSC63	301.8	200	63	M20 x 2.0P	65 Nm	75 Nm	6.81
27.501.63.250	SBT50 x PSC63 - 250	PSC63	351.8	250	63	M20 x 2.0P	65 Nm	75 Nm	7.88
27.501.63.300	SBT50 x PSC63 - 300	PSC63	401.8	300	63	M20 x 2.0P	65 Nm	75 Nm	8.73
27.501.80.070	SBT50 x PSC80 - 70	PSC80	171.8	70	80	M20 x 2.0P	65 Nm	75 Nm	3.91
27.501.80.093	SBT50 x PSC80 - 93	PSC80	194.8	93	80	M20 x 2.0P	65 Nm	75 Nm	4.73
27.501.80.120	SBT50 x PSC80 - 120	PSC80	221.8	120	80	M20 x 2.0P	65 Nm	75 Nm	5.71
27.501.80.183	SBT50 x PSC80 - 183	PSC80	284.8	183	80	M20 x 2.0P	65 Nm	75 Nm	7.98
27.501.80.243	SBT50 x PSC80 - 243	PSC80	344.8	243	80	M20 x 2.0P	65 Nm	75 Nm	10.14

SCAT / PSC ADAPTER

Dual
DRIVE+

SCAT / PSC 法蘭加厚型套筒

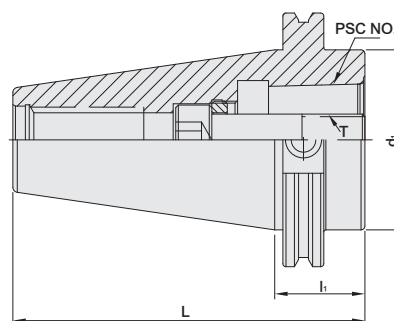

MODEL NO.	TYPE	NO.	L	l ₁	d ₁	T	TORQUE		WEIGHT (KGS)
							MIN.	MAX.	
43.501.32.035	SCAT40 x PSC32 - 35	PSC32	103.249	35	44.45	M12 x 1.5P	45 Nm	55 Nm	1.02
43.501.40.035	SCAT40 x PSC40 - 35	PSC40	103.249	35	44.45	M14 x 1.5P	45 Nm	55 Nm	0.93
43.501.50.035	SCAT40 x PSC50 - 35	PSC50	103.249	35	44.45	M16 x 1.5P	45 Nm	55 Nm	0.85
43.501.63.090	SCAT40 x PSC63 - 90	PSC63	158.249	90	44.45	M20 x 2.0P	65 Nm	75 Nm	1.85
44.501.32.035	SCAT50 x PSC32 - 35	PSC32	136.6	35	69.85	M12 x 1.5P	45 Nm	55 Nm	3.05
44.501.40.035	SCAT50 x PSC40 - 35	PSC40	136.6	35	69.85	M14 x 1.5P	45 Nm	55 Nm	3.00
44.501.50.035	SCAT50 x PSC50 - 35	PSC50	136.6	35	69.85	M16 x 1.5P	45 Nm	55 Nm	2.90
44.501.63.035	SCAT50 x PSC63 - 35	PSC63	136.6	35	69.85	M20 x 2.0P	65 Nm	75 Nm	2.68

INCHES

44.501.63.400	SCAT50 x PSC63 - 4"	PSC63	184.15	101.6	69.85	M20 x 2.0P	65 Nm	75 Nm	4.42
44.501.63.600	SCAT50 x PSC63 - 6"	PSC63	234.95	152.4	69.85	M20 x 2.0P	65 Nm	75 Nm	5.78
44.501.63.800	SCAT50 x PSC63 - 8"	PSC63	285.75	203.2	69.85	M20 x 2.0P	65 Nm	75 Nm	7.14
44.501.63.100	SCAT50 x PSC63 - 10"	PSC63	336.55	254	69.85	M20 x 2.0P	65 Nm	75 Nm	8.50
44.501.63.120	SCAT50 x PSC63 - 12"	PSC63	387.35	304.8	69.85	M20 x 2.0P	65 Nm	75 Nm	9.87
44.501.80.374	SCAT50 x PSC80 - 3.74"	PSC80	196.596	94.996	80.01	M20 x 2.0P	65 Nm	75 Nm	3.05



SDAT / PSC ADAPTER

Dual
DRIVE+

SDAT / PSC 法蘭加厚型套筒

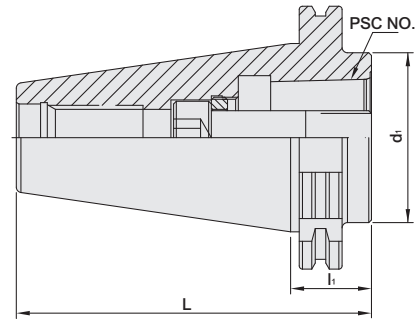

MODEL NO.	TYPE	NO.	L	l ₁	d ₁	T	TORQUE		WEIGHT (KGS)
							MIN.	MAX.	
66.501.32.030	SDAT40 x PSC32 - 30	PSC32	98.4	30	32	M12 x 1.5P	45 Nm	55 Nm	1.40
66.501.40.040	SDAT40 x PSC40 - 40	PSC40	108.4	40	40	M14 x 1.5P	45 Nm	55 Nm	1.50
66.501.50.050	SDAT40 x PSC50 - 50	PSC50	118.4	50	50	M16 x 1.5P	45 Nm	55 Nm	1.60
66.501.63.090	SDAT40 x PSC63 - 90	PSC63	158.4	90	63	M20 x 2.0P	65 Nm	75 Nm	2.00
67.501.32.030	SDAT50 x PSC32 - 30	PSC32	131.75	30	32	M12 x 1.5P	45 Nm	55 Nm	4.20
67.501.40.030	SDAT50 x PSC40 - 30	PSC40	131.75	30	40	M14 x 1.5P	45 Nm	55 Nm	4.30
67.501.50.030	SDAT50 x PSC50 - 30	PSC50	131.75	30	50	M16 x 1.5P	45 Nm	55 Nm	4.40
67.501.63.030	SDAT50 x PSC63 - 30	PSC63	131.75	30	63	M20 x 2.0P	65 Nm	75 Nm	4.50
67.501.63.100	SDAT50 x PSC63 - 100	PSC63	201.75	100	63	M20 x 2.0P	65 Nm	75 Nm	5.00
67.501.63.150	SDAT50 x PSC63 - 150	PSC63	251.75	150	63	M20 x 2.0P	65 Nm	75 Nm	5.20
67.501.63.200	SDAT50 x PSC63 - 200	PSC63	301.75	200	63	M20 x 2.0P	65 Nm	75 Nm	5.40
67.501.63.250	SDAT50 x PSC63 - 250	PSC63	351.75	250	63	M20 x 2.0P	65 Nm	75 Nm	5.80
67.501.63.300	SDAT50 x PSC63 - 300	PSC63	401.75	300	63	M20 x 2.0P	65 Nm	75 Nm	6.20
67.501.80.050	SDAT50 x PSC80 - 50	PSC80	151.75	50	80	M20 x 2.0P	65 Nm	75 Nm	2.90
67.501.80.070	SDAT50 x PSC80 - 70	PSC80	171.75	70	80	M20 x 2.0P	65 Nm	75 Nm	3.30
67.501.80.100	SDAT50 x PSC80 - 100	PSC80	201.75	100	80	M20 x 2.0P	65 Nm	75 Nm	4.00
67.501.80.120	SDAT50 x PSC80 - 120	PSC80	221.75	120	80	M20 x 2.0P	65 Nm	75 Nm	4.70

HSK / PSC ADAPTER

HSK / PSC 套筒

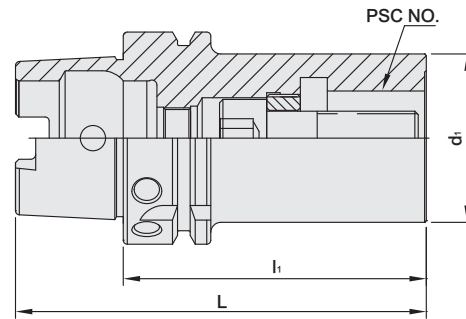

MODEL NO.	TYPE	NO.	L	l ₁	d ₁	T	TORQUE		WEIGHT (KGS)
							MIN.	MAX.	
73.501.32.075	HSK63A x PSC32 - 75	PSC32	107	75	32	M12 x 1.5P	45 Nm	55 Nm	0.92
73.501.40.080	HSK63A x PSC40 - 80	PSC40	112	80	40	M14 x 1.5P	45 Nm	55 Nm	1.06
73.501.50.090	HSK63A x PSC50 - 90	PSC50	122	90	50	M16 x 1.5P	45 Nm	55 Nm	1.39
75.501.32.080	HSK100A x PSC32 - 80	PSC32	130	80	32	M12 x 1.5P	45 Nm	55 Nm	2.25
75.501.40.090	HSK100A x PSC40 - 90	PSC40	140	90	40	M14 x 1.5P	45 Nm	55 Nm	2.43
75.501.50.100	HSK100A x PSC50 - 100	PSC50	150	100	50	M16 x 1.5P	45 Nm	55 Nm	2.80
75.501.63.110	HSK100A x PSC63 - 110	PSC63	160	110	63	M20 x 2.0P	65 Nm	75 Nm	3.41
75.501.63.150	HSK100A x PSC63 - 150	PSC63	200	150	63	M20 x 2.0P	65 Nm	75 Nm	4.18
75.501.63.200	HSK100A x PSC63 - 200	PSC63	250	200	63	M20 x 2.0P	65 Nm	75 Nm	5.14
75.501.63.250	HSK100A x PSC63 - 250	PSC63	300	250	63	M20 x 2.0P	65 Nm	75 Nm	6.10
75.501.63.300	HSK100A x PSC63 - 300	PSC63	350	300	63	M20 x 2.0P	65 Nm	75 Nm	7.07
75.501.80.120	HSK100A x PSC80 - 120	PSC80	170	120	80	M20 x 2.0P	65 Nm	75 Nm	4.93

PSC EXTENSION ADAPTER FOR SAME DIAMETER

PSC等徑套筒

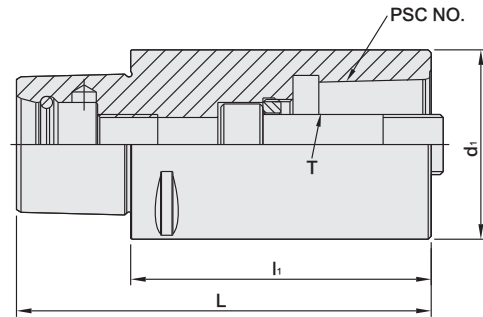
台灣精品2012
TAIWAN EXCELLENCE

MODEL NO.	TYPE	PSC NO.	L	l ₁	d ₁	T	TORQUE		WEIGHT (KGS)
							MIN.	MAX.	
140.501.32.060	PSC32 x PSC32 - 60	PSC32	79	60	32	M12 x 1.5P	45Nm	55Nm	0.40
140.501.32.080	PSC32 x PSC32 - 80	PSC32	99	80	32	M12 x 1.5P	45Nm	55Nm	0.50
141.501.40.060	PSC40 x PSC40 - 60	PSC40	84	60	40	M14 x 1.5P	45Nm	55Nm	0.50
141.501.40.080	PSC40 x PSC40 - 80	PSC40	104	80	40	M14 x 1.5P	45Nm	55Nm	0.70
142.501.50.080	PSC50 x PSC50 - 80	PSC50	110	80	50	M16 x 1.5P	45Nm	55Nm	1.10
142.501.50.100	PSC50 x PSC50 - 100	PSC50	130	100	50	M16 x 1.5P	45Nm	55Nm	1.40
143.501.63.080	PSC63 x PSC63 - 80	PSC63	118	80	63	M20 x 2.0P	65Nm	75Nm	2.00
143.501.63.100	PSC63 x PSC63 - 100	PSC63	138	100	63	M20 x 2.0P	65Nm	75Nm	2.20
144.501.80.065	PSC80 x PSC80 - 65	PSC80	113	65	80	M20 x 2.0P	65Nm	75Nm	3.10
144.501.80.100	PSC80 x PSC80 - 100	PSC80	148	100	80	M20 x 2.0P	65Nm	75Nm	3.60
144.501.80.125	PSC80 x PSC80 - 125	PSC80	173	125	80	M20 x 2.0P	65Nm	75Nm	4.60
145.501.80.065	PSC80X x PSC80 - 65	PSC80	113	65	80	M20 x 2.0P	65Nm	75Nm	4.00
145.501.80.100	PSC80X x PSC80 - 100	PSC80	148	100	80	M20 x 2.0P	65Nm	75Nm	4.40
145.501.80.150	PSC80X x PSC80 - 150	PSC80	198	150	80	M20 x 2.0P	65Nm	75Nm	7.30
145.501.80X.100	PSC80X x PSC80X - 100	PSC80X	148	100	100	M20 x 2.0P	65Nm	75Nm	5.80

PSC EXTENSION ADAPTER

FOR DIFFERENT DIAMETER

PSC異徑套筒



台灣精品2012
TAIWAN EXCELLENCE

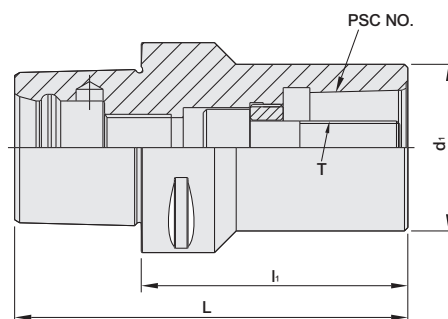

MODEL NO.	TYPE	NO.	L	l ₁	d ₁	T	TORQUE		WEIGHT (KGS)
							MIN.	MAX.	
141.501.32.055	PSC40 x PSC32 - 55	PSC32	79	55	32	M12 x 1.5P	45 Nm	55 Nm	0.50
141.501.32.070	PSC40 x PSC32 - 70	PSC32	94	70	32	M12 x 1.5P	45 Nm	55 Nm	0.60
142.501.32.060	PSC50 x PSC32 - 60	PSC32	90	60	32	M12 x 1.5P	45 Nm	55 Nm	0.60
142.501.40.065	PSC50 x PSC40 - 65	PSC40	95	65	40	M14 x 1.5P	45 Nm	55 Nm	0.80
142.501.40.085	PSC50 x PSC40 - 85	PSC40	115	85	40	M14 x 1.5P	45 Nm	55 Nm	1.10
143.501.32.070	PSC63 x PSC32 - 70	PSC32	108	70	32	M12 x 1.5P	45 Nm	55 Nm	1.10
143.501.40.080	PSC63 x PSC40 - 80	PSC40	118	80	40	M14 x 1.5P	45 Nm	55 Nm	1.20
143.501.50.080	PSC63 x PSC50 - 80	PSC50	118	80	50	M16 x 1.5P	45 Nm	55 Nm	1.50
143.501.50.110	PSC63 x PSC50 - 110	PSC50	148	110	50	M16 x 1.5P	45 Nm	55 Nm	2.20
144.501.32.060	PSC80 x PSC32 - 60	PSC32	108	60	32	M12 x 1.5P	45 Nm	55 Nm	1.70
144.501.40.070	PSC80 x PSC40 - 70	PSC40	118	70	40	M14 x 1.5P	45 Nm	55 Nm	1.90
144.501.50.045	PSC80 x PSC50 - 45	PSC50	93	45	50	M16 x 1.5P	45 Nm	55 Nm	1.50
144.501.50.080	PSC80 x PSC50 - 80	PSC50	128	80	50	M16 x 1.5P	45 Nm	55 Nm	2.20
144.501.63.055	PSC80 x PSC63 - 55	PSC63	103	55	63	M20 x 2.0P	65 Nm	75 Nm	2.30
144.501.63.080	PSC80 x PSC63 - 80	PSC63	128	80	63	M20 x 2.0P	65 Nm	75 Nm	2.50
144.501.63.120	PSC80 x PSC63 - 120	PSC63	168	120	63	M20 x 2.0P	65 Nm	75 Nm	4.00
145.501.63.055	PSC80X x PSC63 - 55	PSC63	103	55	63	M20 x 2.0P	65 Nm	75 Nm	3.00
145.501.63.080	PSC80X x PSC63 - 80	PSC63	128	80	63	M20 x 2.0P	65 Nm	75 Nm	3.40



MEMO

Blank memo area consisting of 18 horizontal grey bars for writing.



MEMO

Blank memo area consisting of 18 horizontal grey bars for writing.



CATALOG 2019-Mar.-Ver.1



SHIN-YAIN INDUSTRIAL CO., LTD.
SHINTEK MACHINERY CO., LTD.

No.198, Jingpu Rd., Qingshui Dist., Taichung City 436, Taiwan
Tel: +886-4-26237575 | Fax: +886-4-26237676 | E-mail: sales@syic.com

